

9 Acres

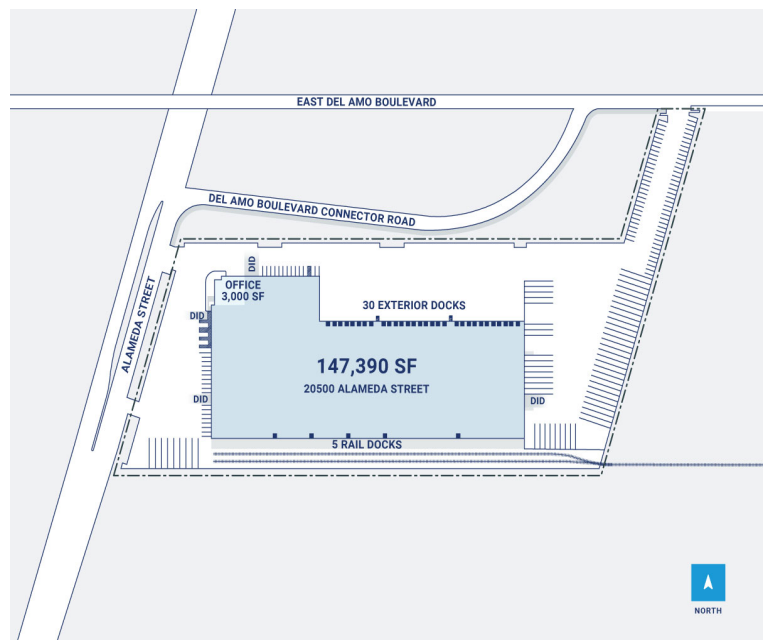

CenterPoint Properties

20500 S. Alameda Street, Carson, CA

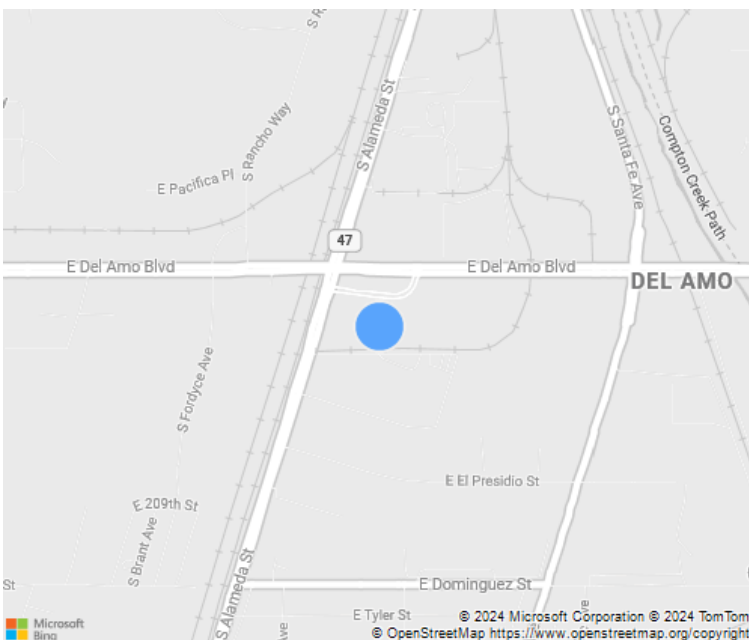

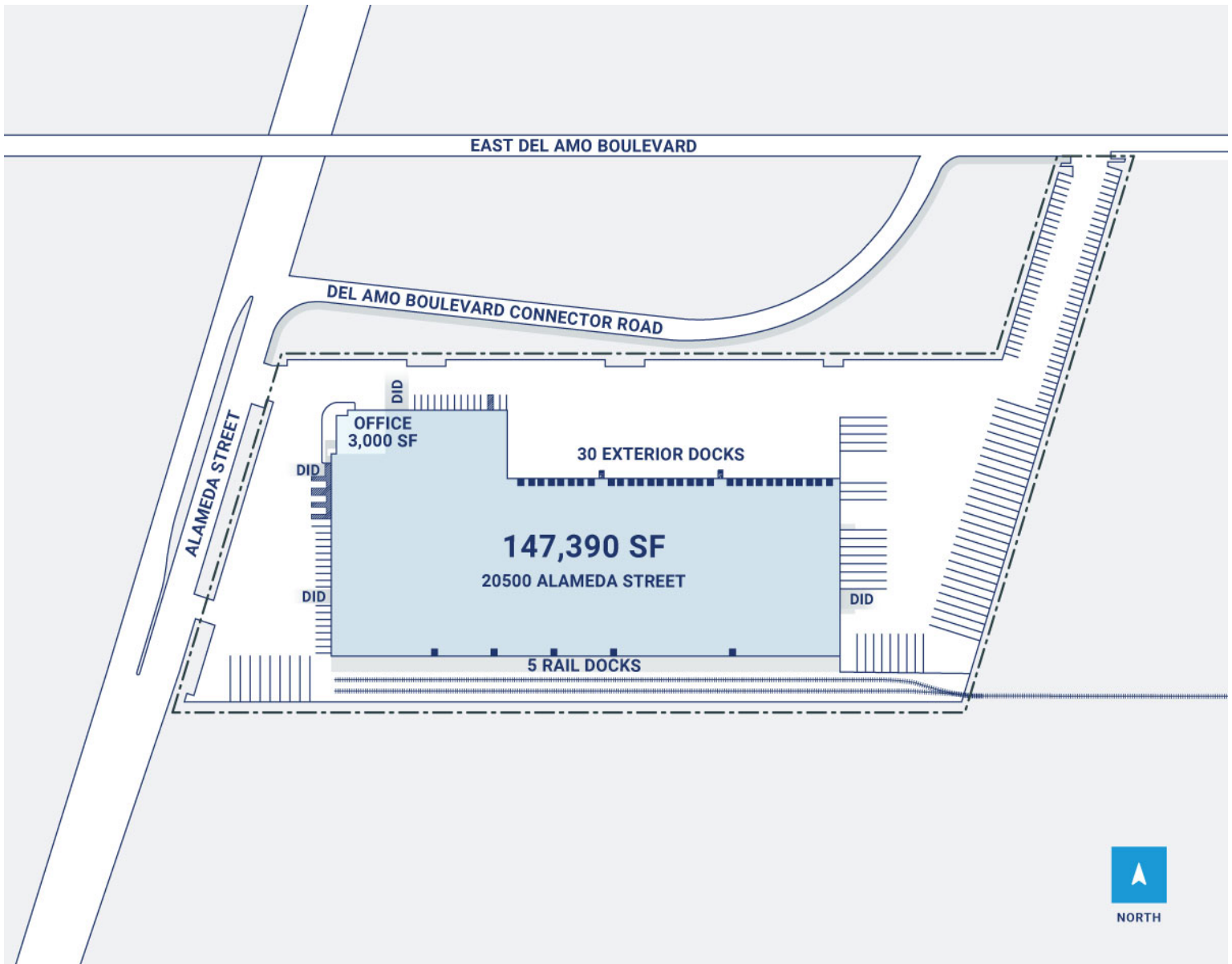

Property Description

Market: Los Angeles

Land: 9 Acres

Building: 147,390 SF

Office: 3,000 SF

Available: SF

Year Built: 1984

Rail Access: Yes

Renovated:

Car Parking: 99 spaces

Trailer Parking: 56 spaces

Clear Height: 28'

Exterior Docks: 30

Interior Docks: 0

Drive-In Doors: 4

Construction: Concrete tilt up and with wood roof decking, concrete d

Roof: Built up

HVAC: Electric Heat

Sprinkler: Yes, current

Power: 277/480 volts, 3-phse, 3-wire, 800-amps-warehouse, 120/208 v

Typical Bay Size: 65' x 48'

Available Units: 0