

7 Acres

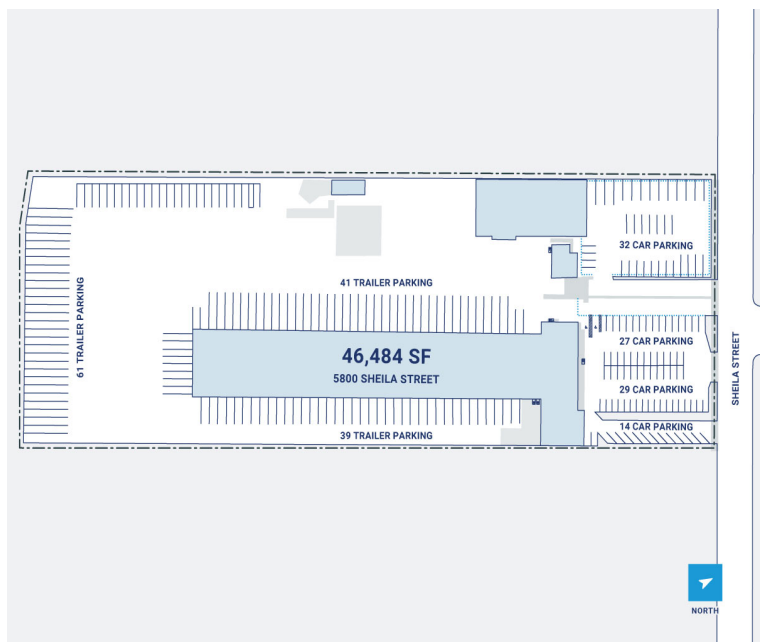

# CenterPoint Properties

5800 Sheila Street, Commerce, CA

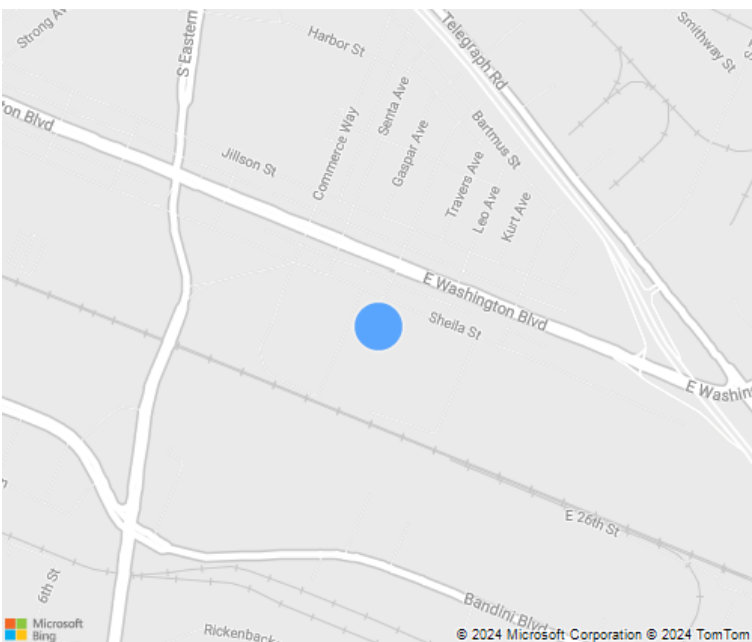

# CenterPoint Properties

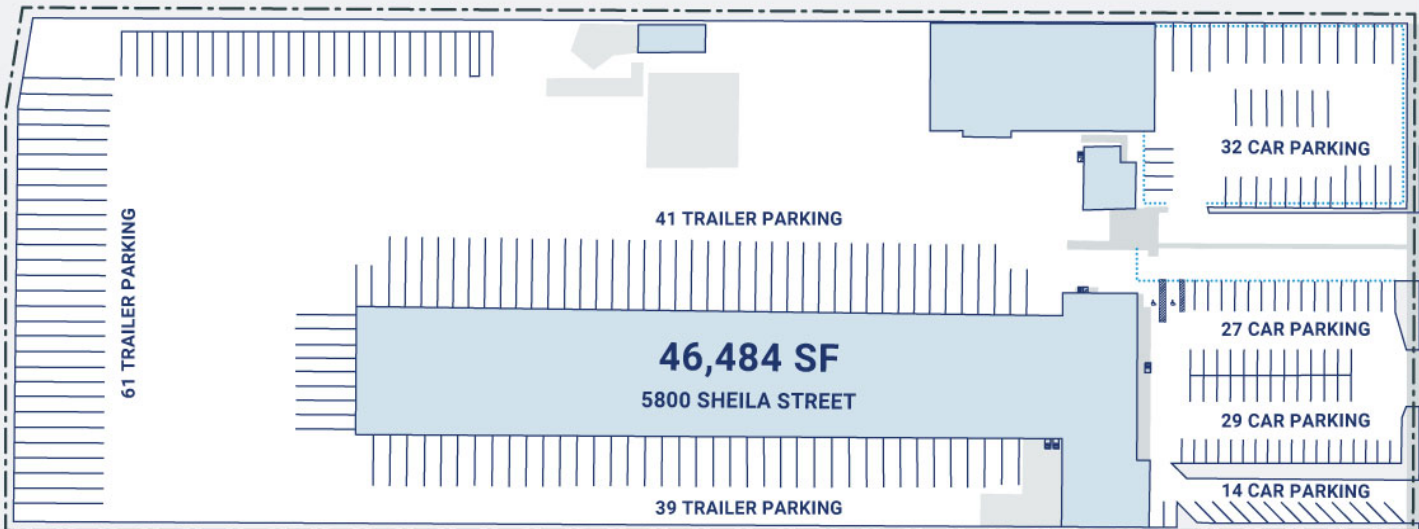

## Property Description

**Market:** Los Angeles

**Land:** 7 Acres

**Building:** 46,484 SF

**Office:** 15,200 SF

**Available:** SF

**Year Built:** 1960

**Rail Access:** No

**Renovated:** 1992

**Car Parking:** 94 spaces

**Trailer Parking:** 134 spaces

**Clear Height:** 16'

**Exterior Docks:** 70

**Interior Docks:** 0

**Drive-In Doors:** 7

**Construction:** VB Masonry, wood frame roof

**Roof:** Built up section w/coating / built up gravel

**HVAC:** AC, Electric Heat, No HVAC

**Sprinkler:** Wet system

**Power:** Voltage/Amps: 600 amps, 277 volt, 3 phase, 4 wire from the p

**Typical Bay Size:** 14' x 10'

**Available Units:** 0