

12 Acres

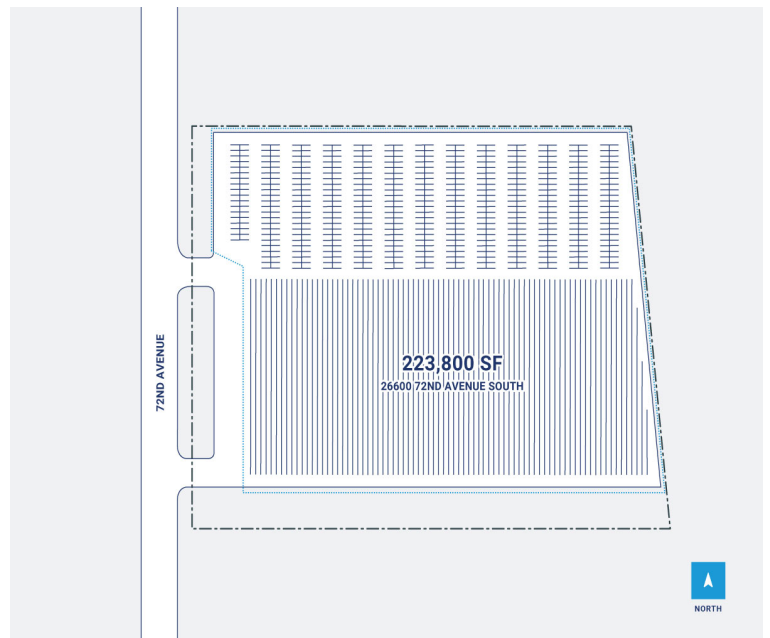

CenterPoint Properties

26600 72nd Avenue South, Kent, WA

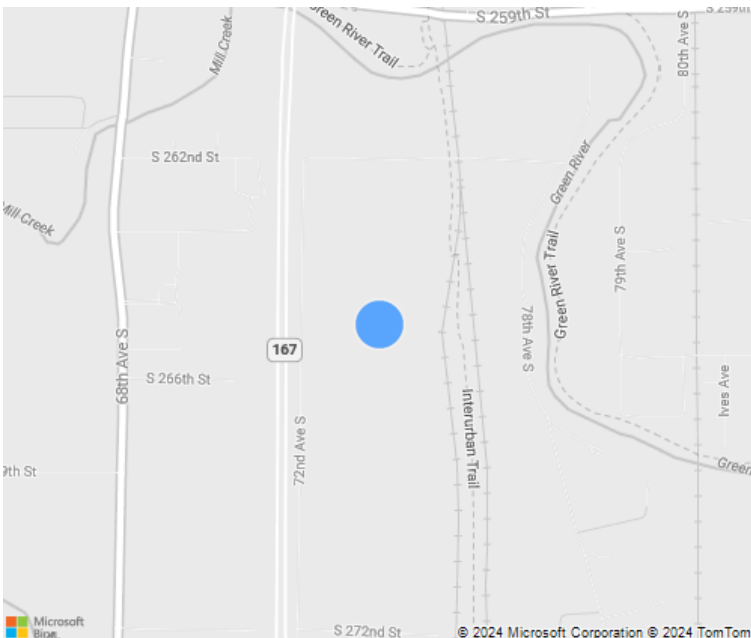

CenterPoint Properties

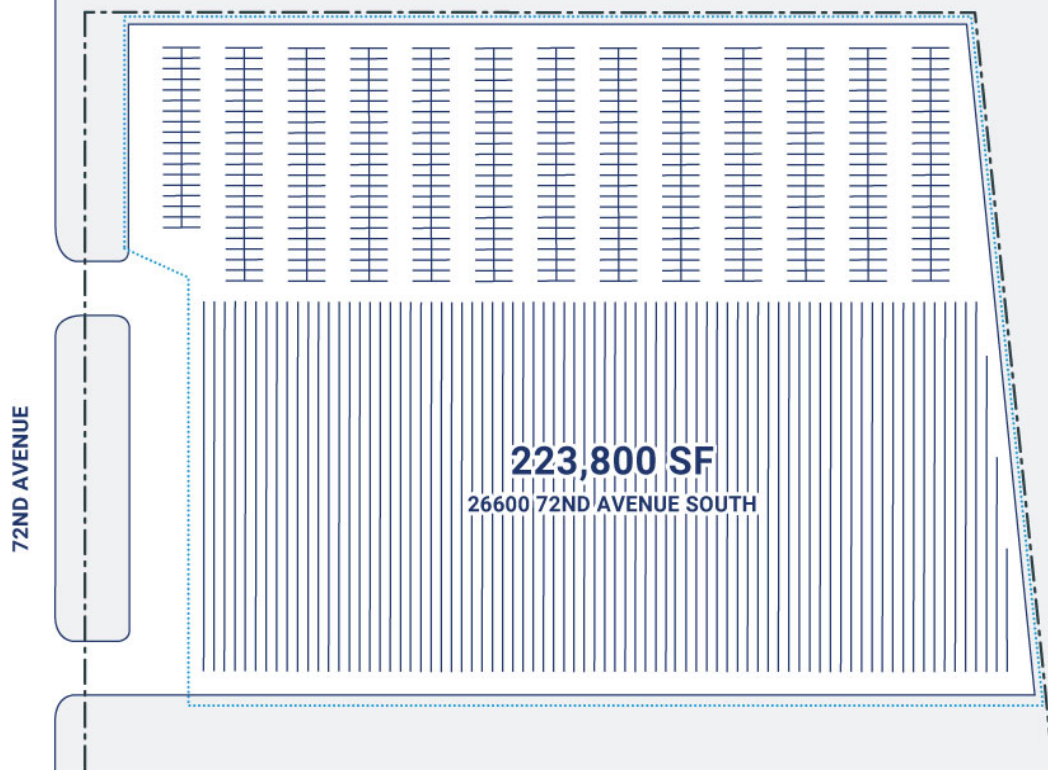

Property Description

Market: Seattle

Land: 12 Acres

Building: 223,800 SF

Office: 0 SF

Available: 0 SF

Year Built: 1998

Rail Access: No

Renovated:

Car Parking: 562 spaces

Trailer Parking: 0 spaces

Clear Height: 36'

Exterior Docks: 33

Interior Docks: 0

Drive-In Doors: 2

Construction: Concrete

Roof: Mechanically fastened TPO. 20 year warranty.

HVAC: Gas Heat, No HVAC

Sprinkler: Yes

Power: capacity unknown

Typical Bay Size: 54' x 56'

Available Units: 1