

167 Acres

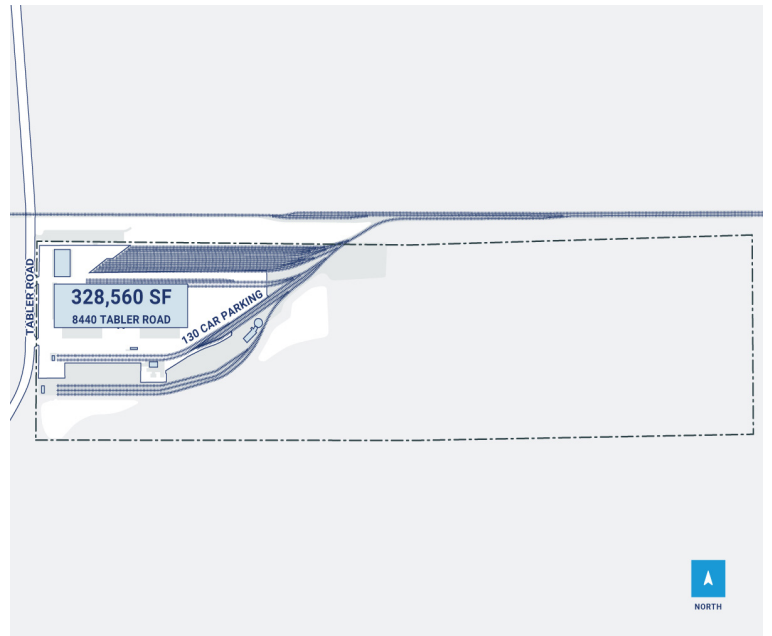

CenterPoint Properties

8440 S Tabler Road, Morris, IL

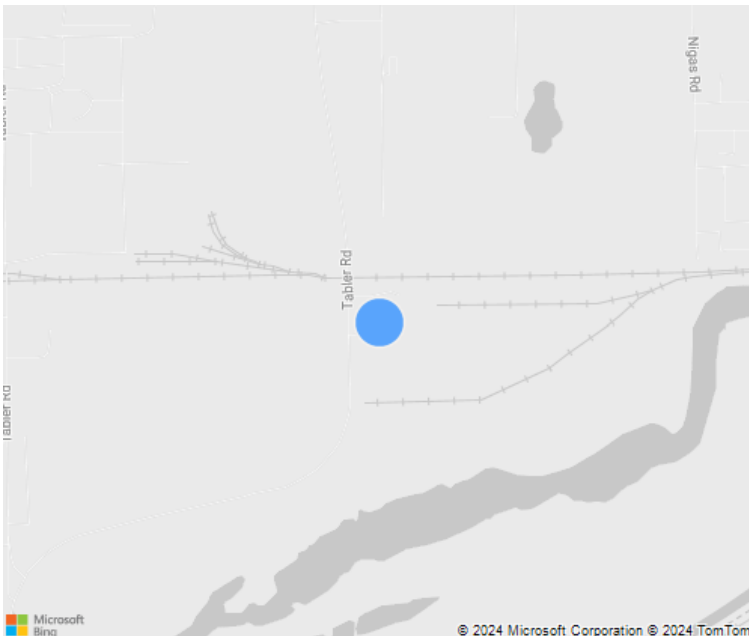

CenterPoint Properties

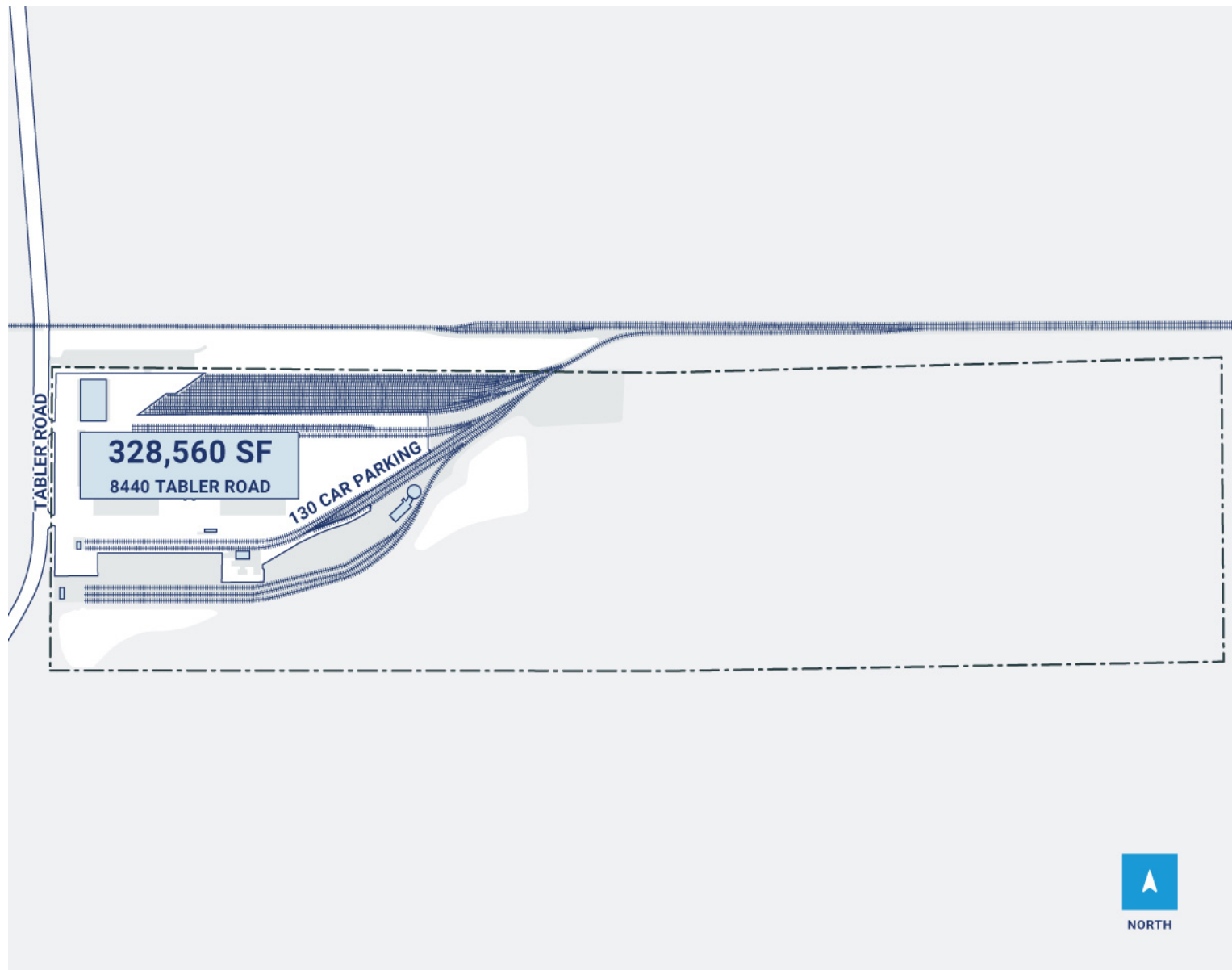

Property Description

Market: Chicago

Land: 167 Acres

Building: 328,560 SF

Office: 43,000 SF

Available: SF

Year Built: 1999

Rail Access: Yes

Renovated:

Car Parking: 130 spaces

Trailer Parking: 0 spaces

Clear Height: 34'

Exterior Docks: 15

Interior Docks: 0

Drive-In Doors: 40

Construction: Load bearing precast tilt-up panels and steel frame

Roof: Built up with pea gravel for the maintenance wash building, river rock for the rest of the building

HVAC: AC, Gas Heat

Sprinkler: Wet System

Power: 277/480 volt, one at 2,500-amps, two at 800-amps, one at 400-amps

Typical Bay Size: 52' x 28'

Available Units: 0