

3 Acres

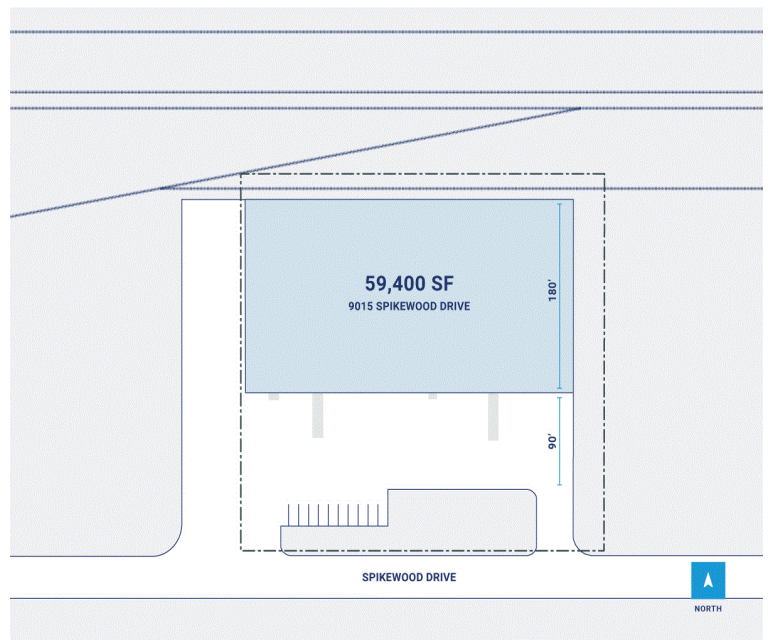

# CenterPoint Properties

9015 Spikewood Drive, Houston , TX

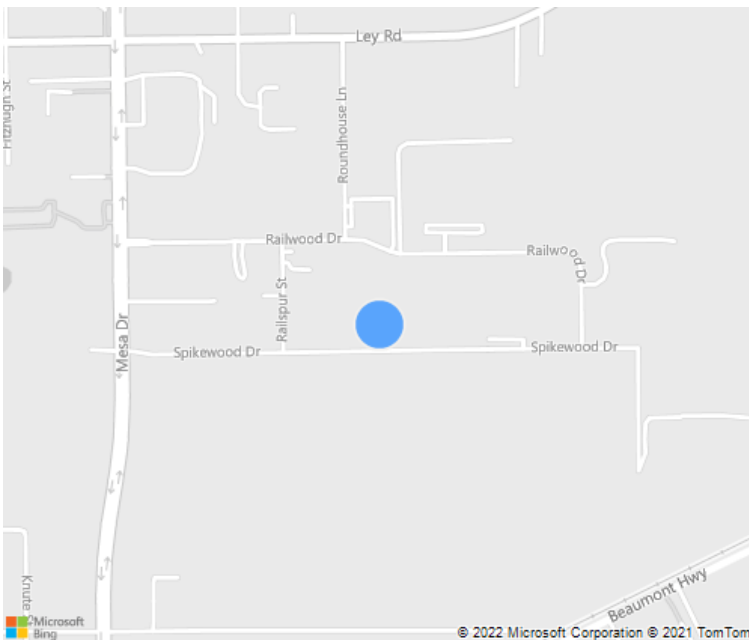

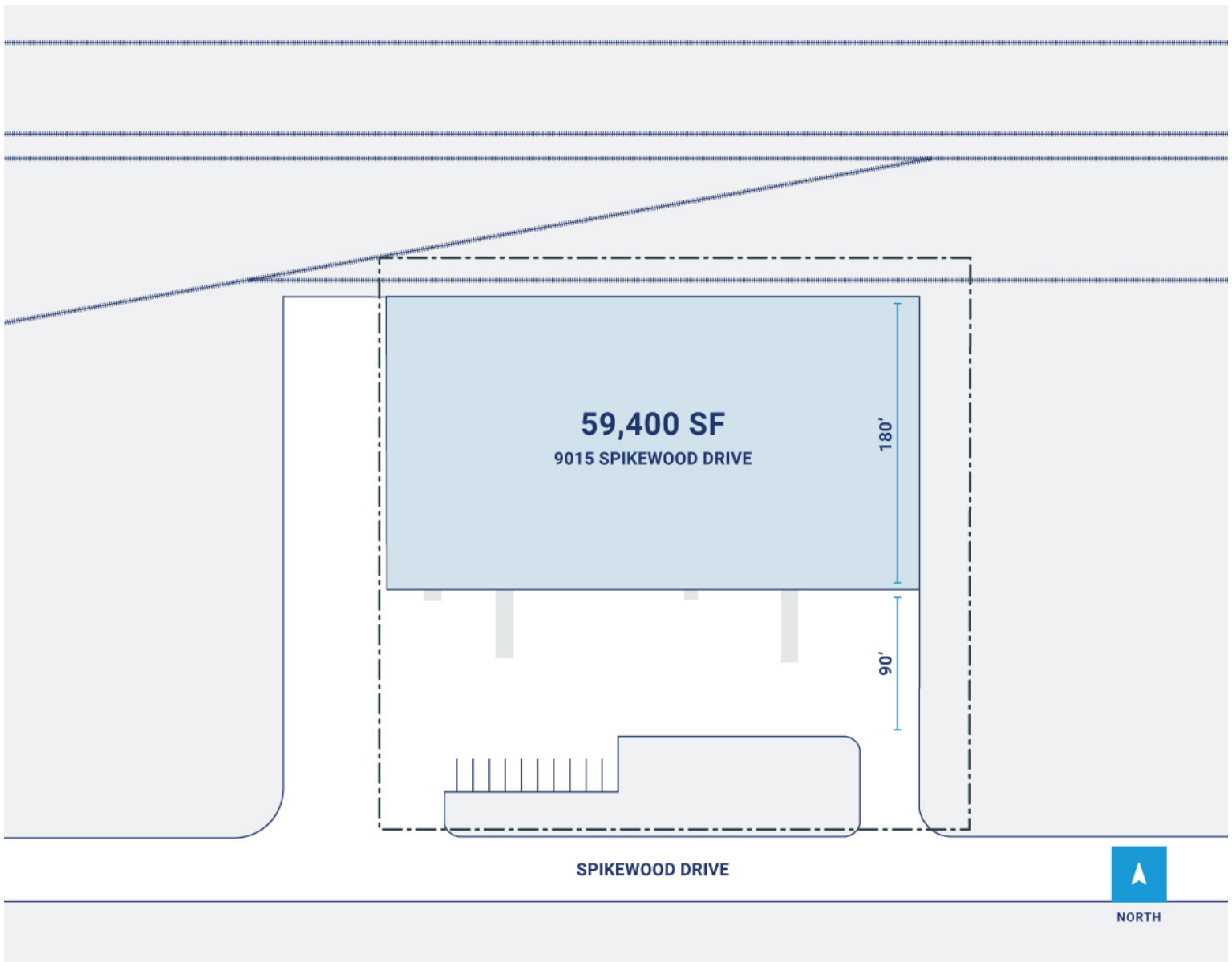

## Property Description

**Market:** Houston

**Land:** 3 Acres

**Building:** 59,400 SF

**Office:** 2,626 SF

**Available:** SF

**Year Built:** 1979

**Rail Access:** Yes

**Renovated:**

**Car Parking:** 38 spaces

**Trailer Parking:** 0 spaces

**Clear Height:** 22'

**Exterior Docks:** 9

**Interior Docks:** 0

**Drive-In Doors:** 3

**Construction:** Concrete perimeter bearing walls, steel interior ...

**Roof:** BUR with granule surface

**HVAC:** AC, Gas Heat

**Sprinkler:** Wet systems

**Power:** 277/480 volts, three phase, four wire from an ove...

**Typical Bay Size:** 36' x 30'

**Available Units:** 0