

4 Acres

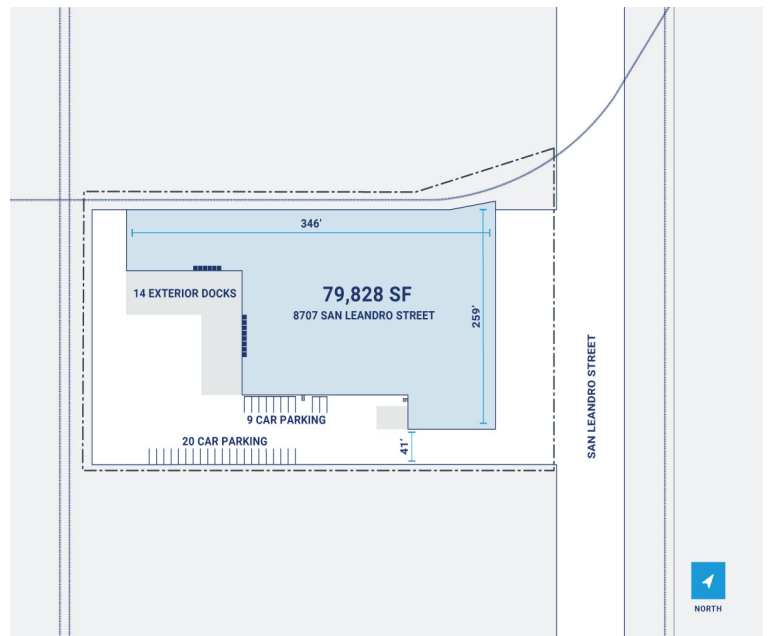

CenterPoint Properties

8707 San Leandro Street, Oakland, CA

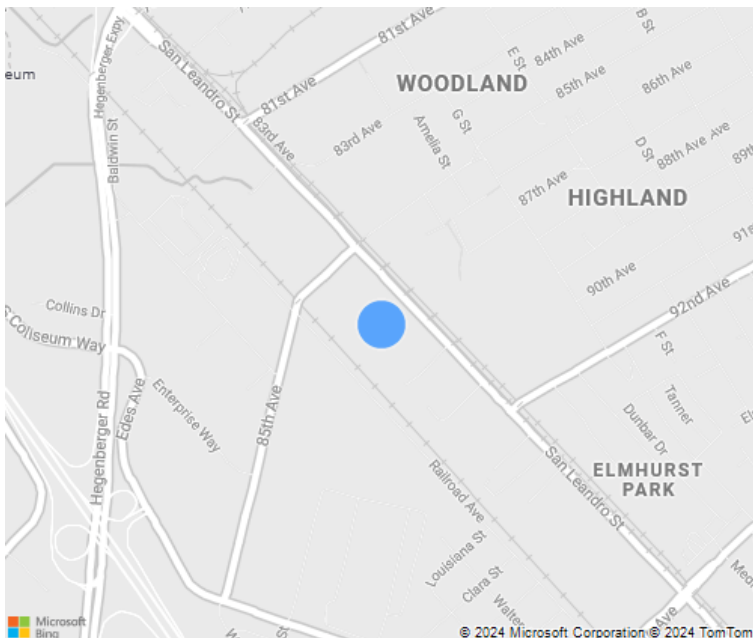

CenterPoint Properties

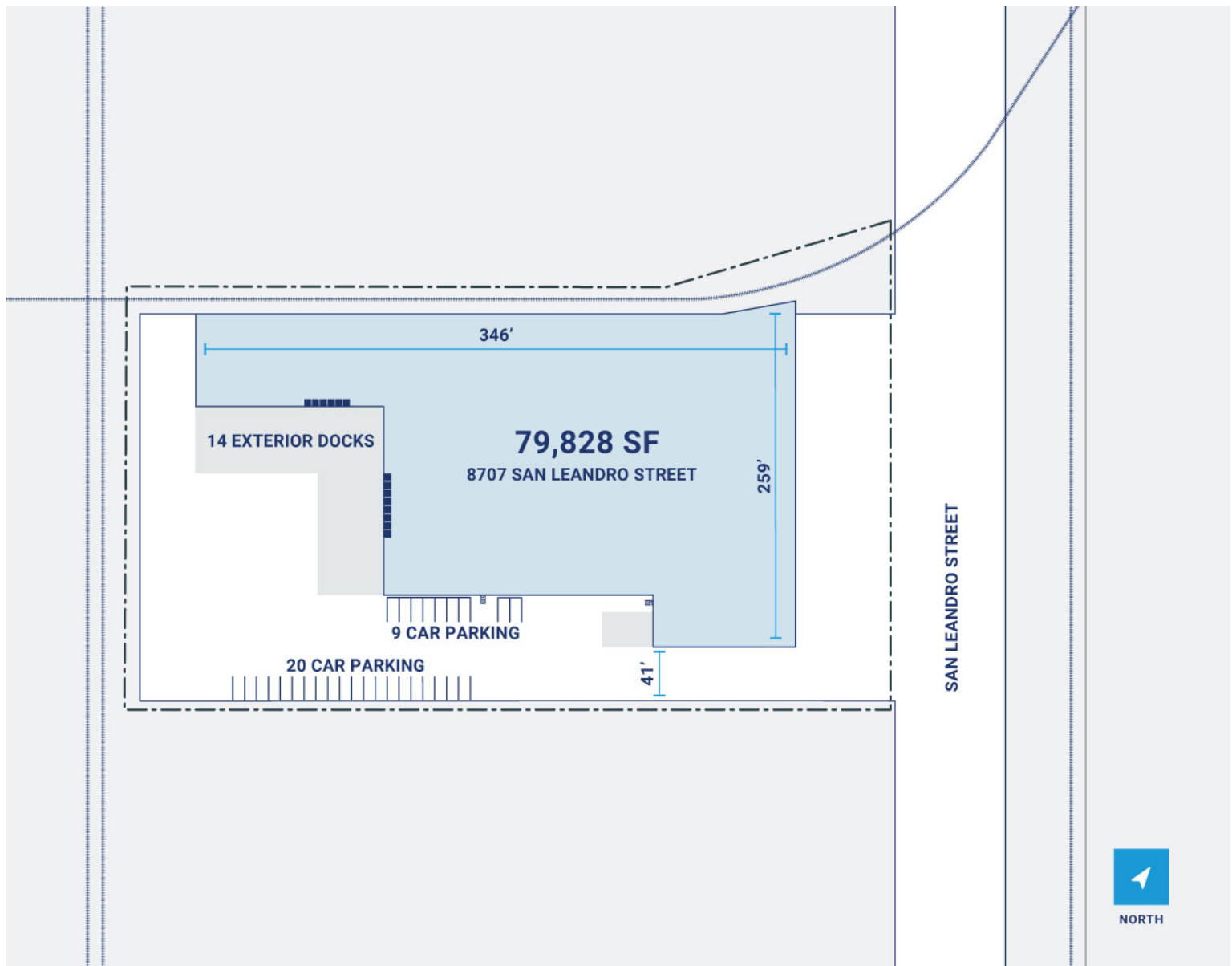

Property Description

Market: Oakland

Land: 4 Acres

Building: 81,823 SF

Office: 0 SF

Available: SF

Year Built: 1968

Rail Access: No

Renovated: 1972

Car Parking: 29 spaces

Trailer Parking: 45 spaces

Clear Height: 24'

Exterior Docks: 18

Interior Docks: 0

Drive-In Doors: 2

Construction: Tilt-up concrete with wood frame roof

Roof: Mineral surfaced 3-ply & base built-up over original low slope,

HVAC: AC, Gas Heat, No HVAC

Sprinkler: Wet system (two 8" risers & one 6" riser)

Power: 600 amperes, 120/240-volt, single phase, 3-wire

Typical Bay Size: 70' x 20'

Available Units: 0