

11 Acres

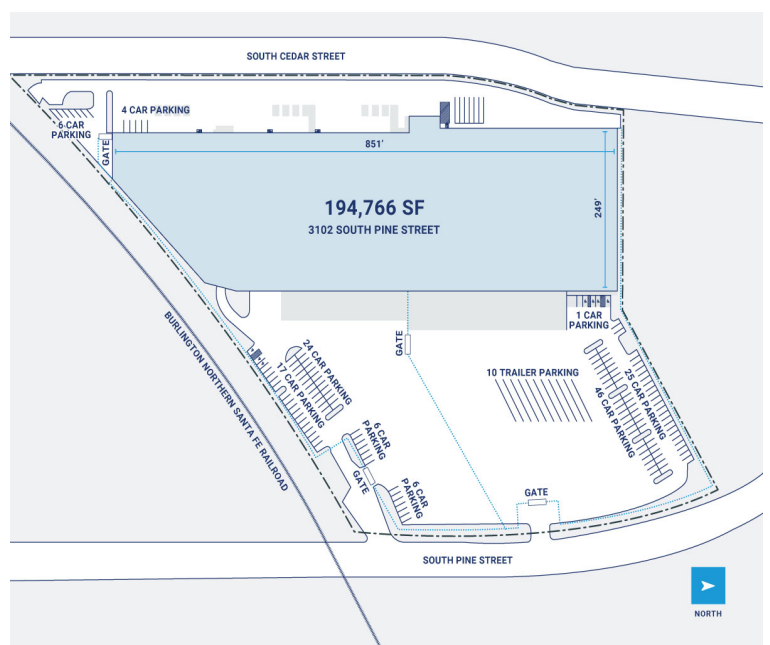

CenterPoint Properties

3102 South Pine Street , Tacoma , WA

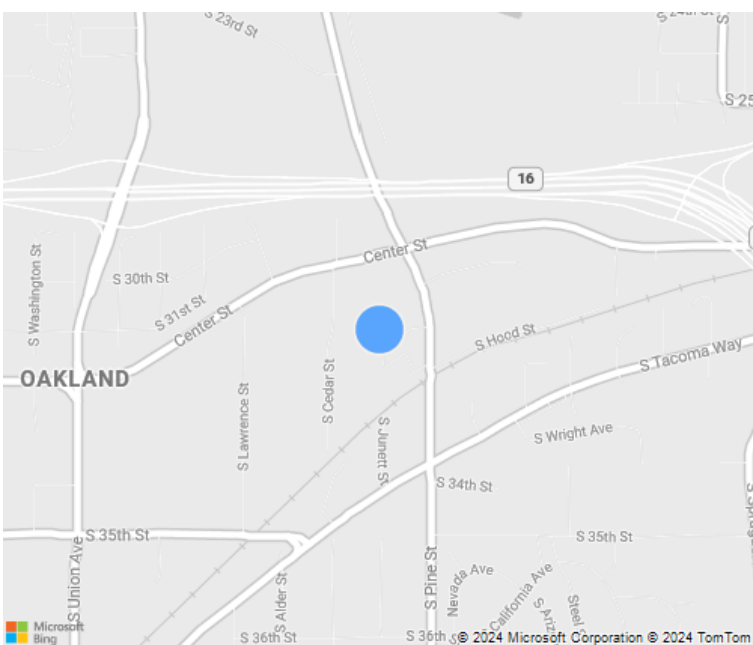

CenterPoint Properties

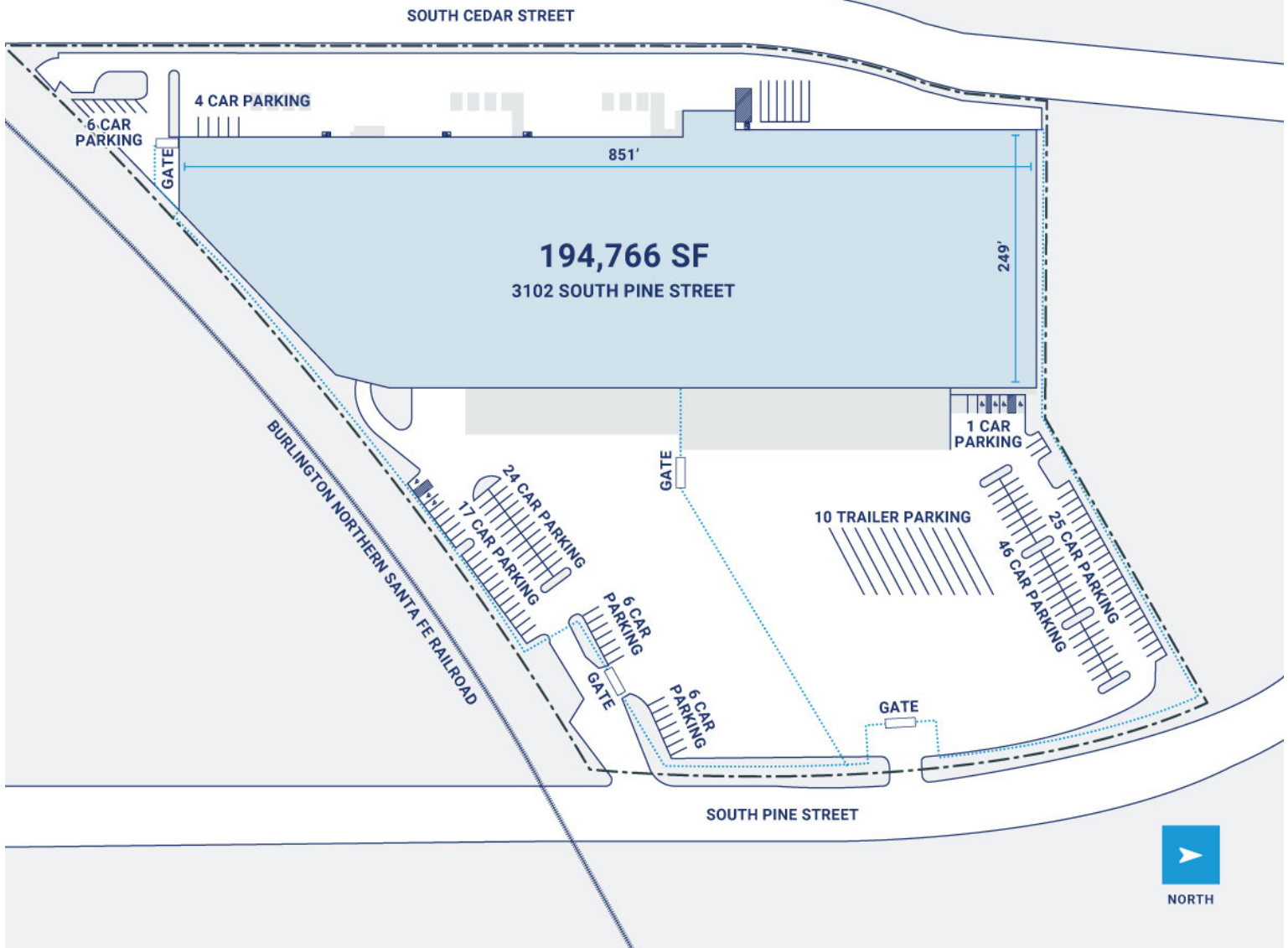

Property Description

Market: Seattle

Land: 11 Acres

Building: 194,857 SF

Office: 2,500 SF

Available: SF

Year Built: 2018

Rail Access: Yes

Renovated: 2001

Car Parking: 132 spaces

Trailer Parking: 65 spaces

Clear Height: 30'

Exterior Docks: 52

Interior Docks: 0

Drive-In Doors: 4

Construction: Timber columns and beams supporting wood joists

Roof: BUR

HVAC: Gas Heat w/ AC

Sprinkler: Combination wet and dry

Power: 5,000 amp 480Y/277 volt, 3-phase, 4-wire

Typical Bay Size: 45' x 49'

Available Units: 0