

8 Acres

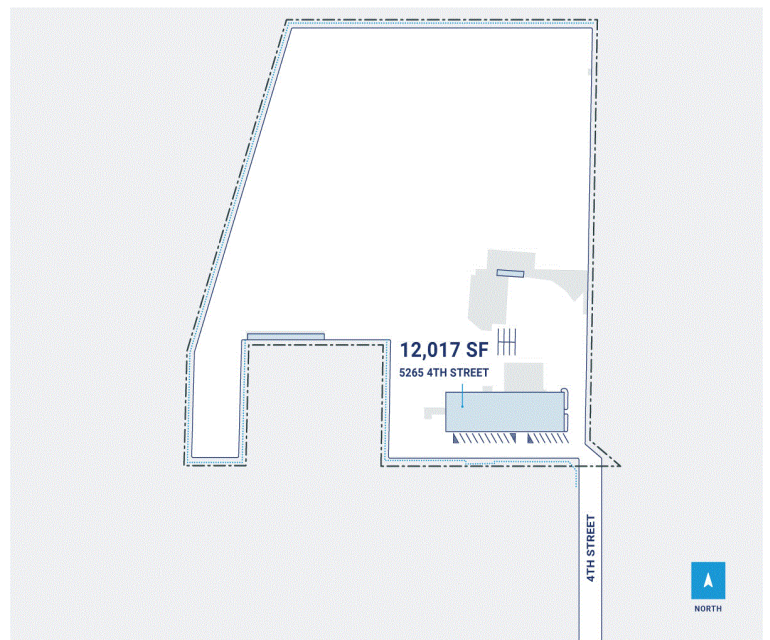

# CenterPoint Properties

5265 4th Street, Irwindale, CA

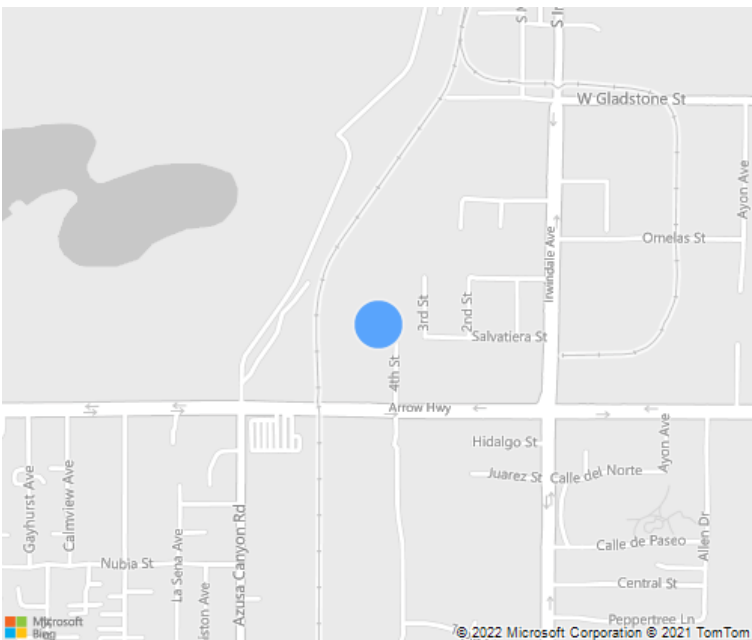

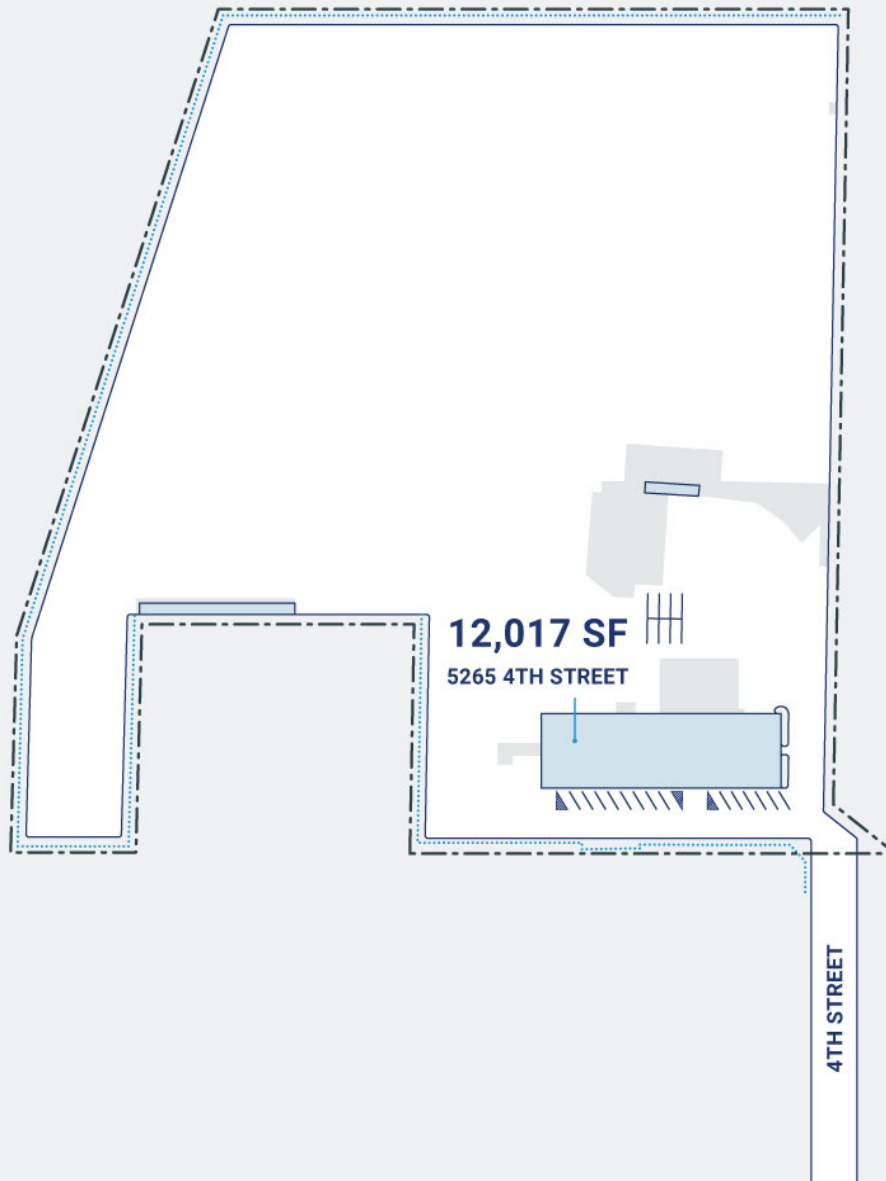

## Property Description

**Market:** Los Angeles

**Land:** 8 Acres

**Building:** 12,417 SF

**Office:** 0 SF

**Available:** SF

**Year Built:** 1925

**Rail Access:** No

**Renovated:**

**Car Parking:** 20 spaces

**Trailer Parking:** 0 spaces

**Clear Height:** 13'

**Exterior Docks:** 0

**Interior Docks:** 0

**Drive-In Doors:** 6

**Construction:** Masonry walls, wood columns and roof frame

**Roof:** Built-up at office and storage; asphalt shingles a...

**HVAC:** Gas Heat w/ AC

**Sprinkler:**

**Power:** Overhead feed; 120/240 volt; 3-phase; one 3-pole...

**Typical Bay Size:** 0' x 0'

**Available Units:** 0