

5 Acres

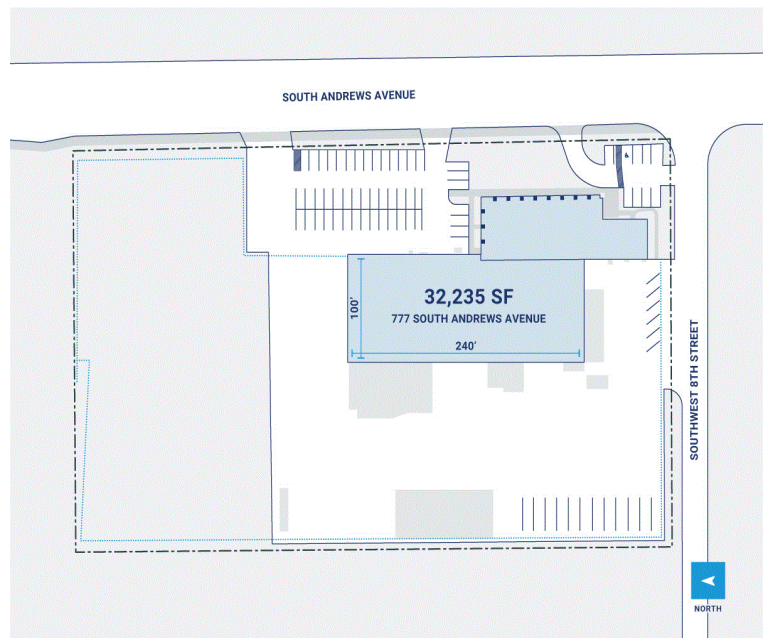

CenterPoint Properties

777 South Andrews , Pompano Beach, FL

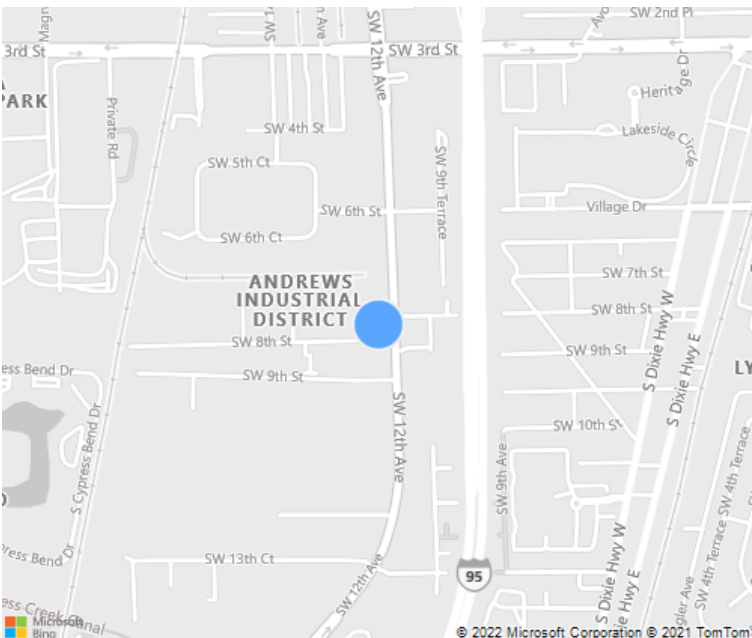

SOUTH ANDREWS AVENUE

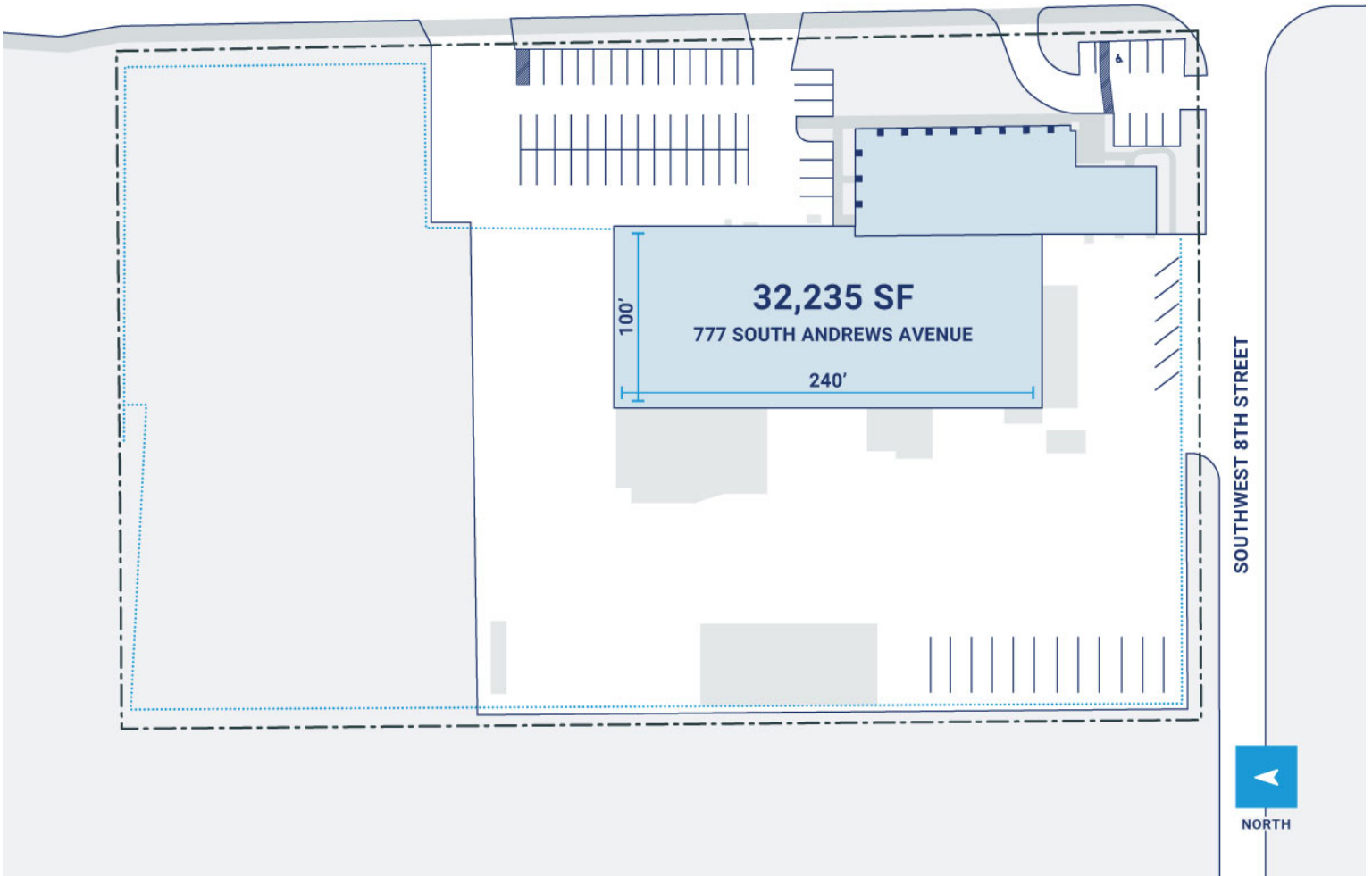

Property Description

Market: South Florida

Land: 5 Acres

Building: 32,235 SF

Office: 8,883 SF

Available: SF

Year Built: 1967

Rail Access: No

Renovated:

Car Parking: 56 spaces

Trailer Parking: 0 spaces

Clear Height: 20'

Exterior Docks: 0

Interior Docks: 0

Drive-In Doors: 9

Construction: Office-Precast Concrete Panel/Shop-Metal Panel

Roof: Metal paneling, Precast concrete panels

HVAC: Gas Heat w/ AC

Sprinkler: Wet

Power: 1,200 amps, 240/120 volt single-phase three wire ...

Typical Bay Size: 0' x 0'

Available Units: 0