

6 Acres

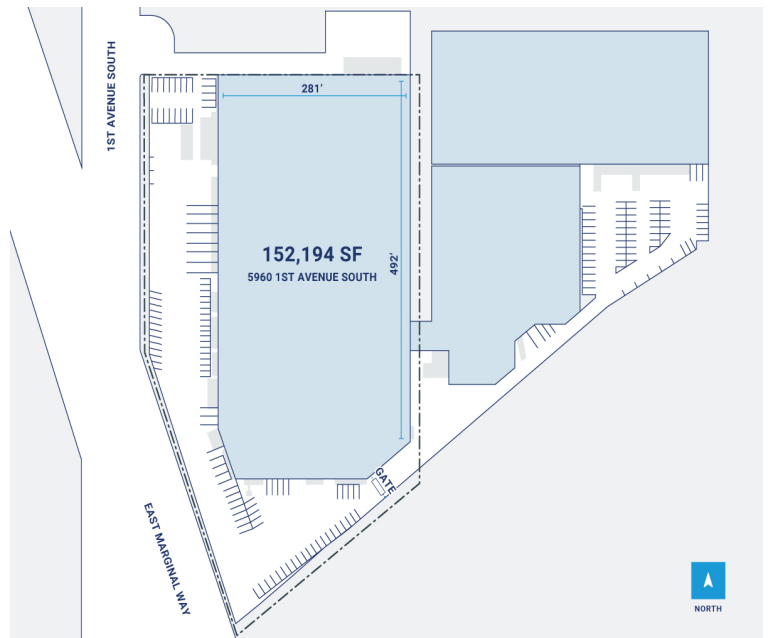

CenterPoint Properties

5960 1st Avenue S, Seattle, WA

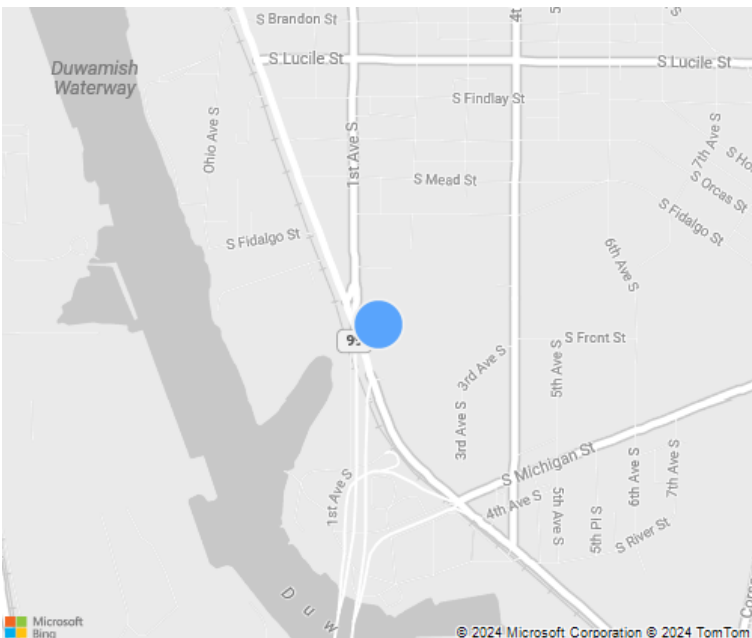

CenterPoint Properties

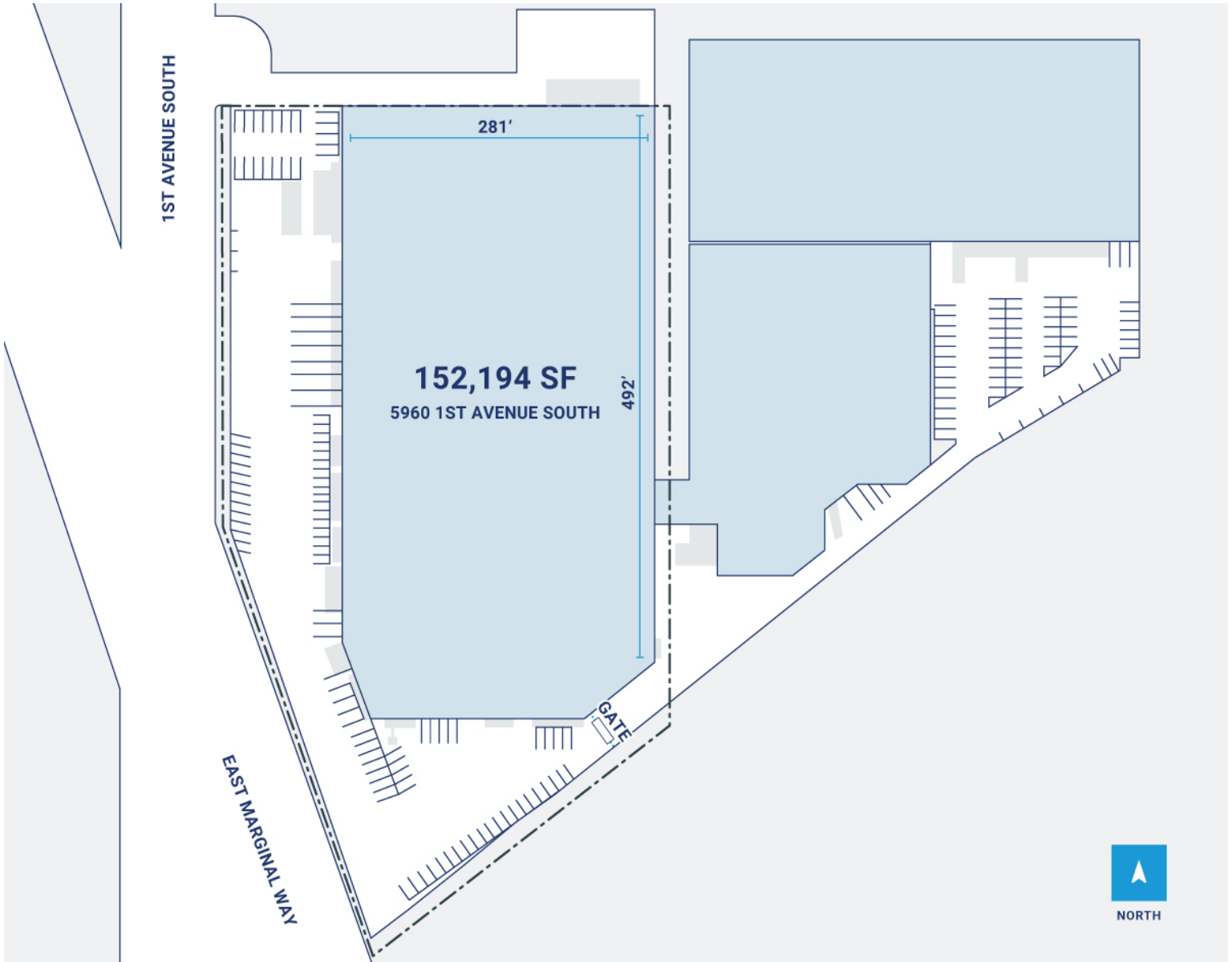

Property Description

Market: Seattle

Land: 6 Acres

Building: 150,100 SF

Office: 0 SF

Available: 84,999 SF

Year Built: 1967

Rail Access: Yes

Renovated:

Car Parking: 92 spaces

Trailer Parking: 2 spaces

Clear Height: 22'

Exterior Docks: 108

Interior Docks: 0

Drive-In Doors: 4

Construction: Concrete tilt-up, wood roof framing

Roof: Single-ply

HVAC: AC, Electric Heat, Gas Heat w/ AC, No HVAC

Sprinkler: Wet/Dry System

Power: None-signage only

Typical Bay Size: 25' x 54'

Available Units: 2