

4 Acres

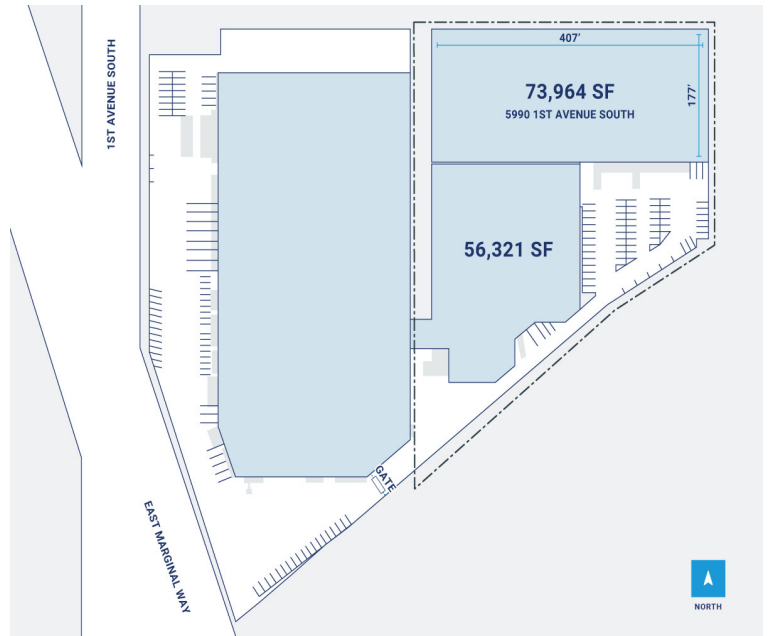

# CenterPoint Properties

5990 1st Avenue S, Seattle, WA

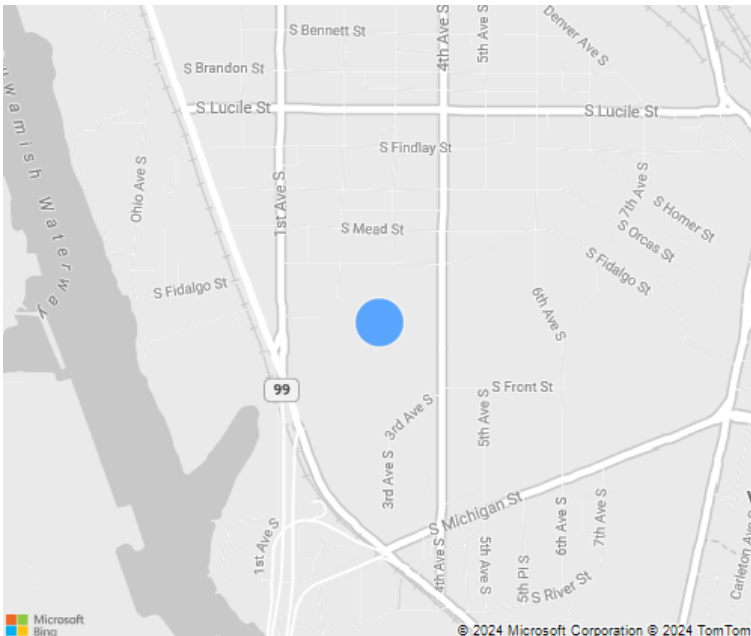

# CenterPoint Properties

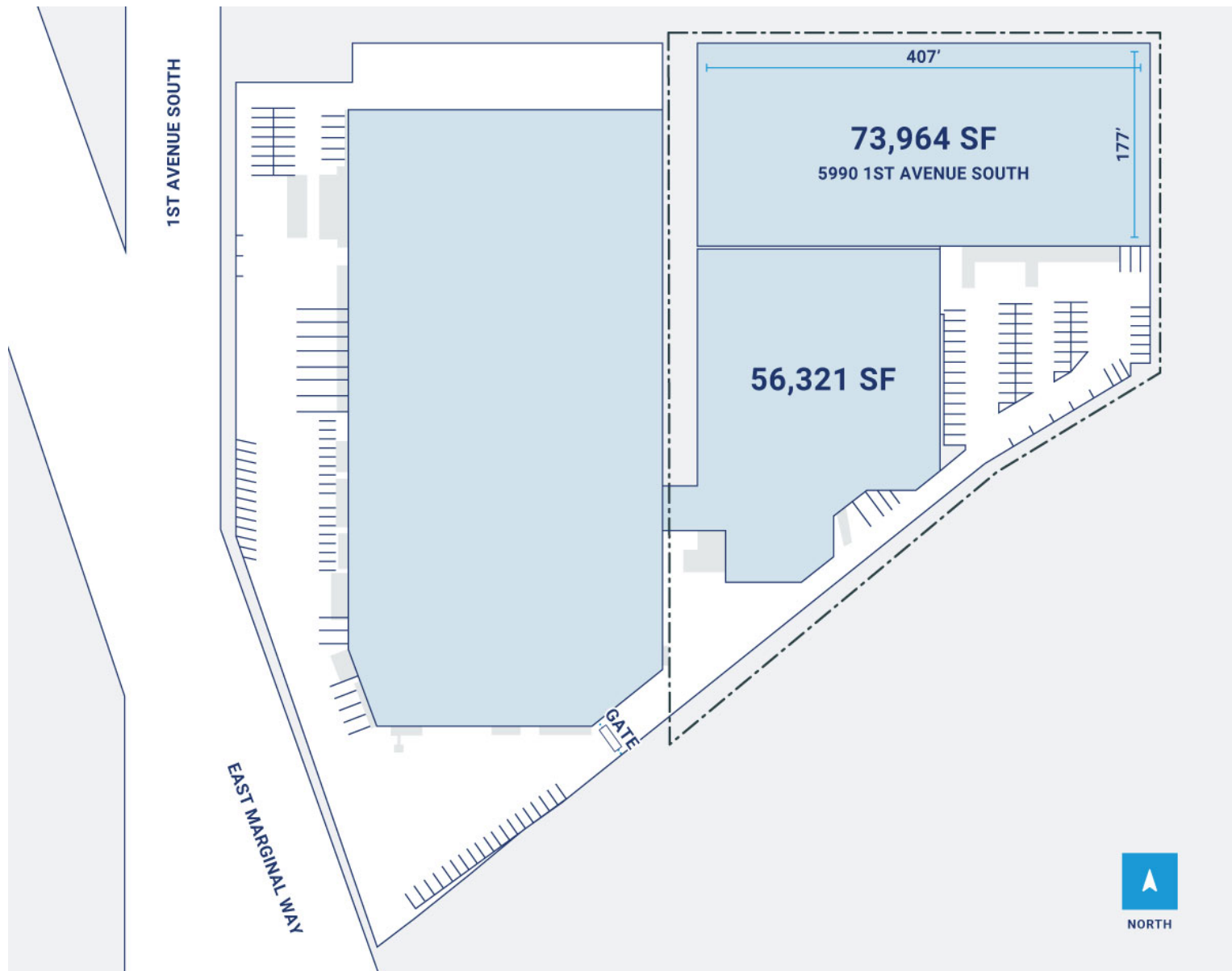

## Property Description

**Market:** Seattle

**Land:** 4 Acres

**Building:** 128,336 SF

**Office:** 0 SF

**Available:** 36,592 SF

**Year Built:** 1967

**Rail Access:** Yes

**Renovated:** 1976

**Car Parking:** 59 spaces

**Trailer Parking:** 0 spaces

**Clear Height:** 22'

**Exterior Docks:** 21

**Interior Docks:** 0

**Drive-In Doors:** 2

**Construction:** Concrete tilt-up

**Roof:** Single-Ply

**HVAC:** AC, Electric Heat, Gas Heat w/ AC

**Sprinkler:** Wet/Dry System

**Power:** 600 amps

**Typical Bay Size:** 40' x 50'

**Available Units:** 1