

3 Acres

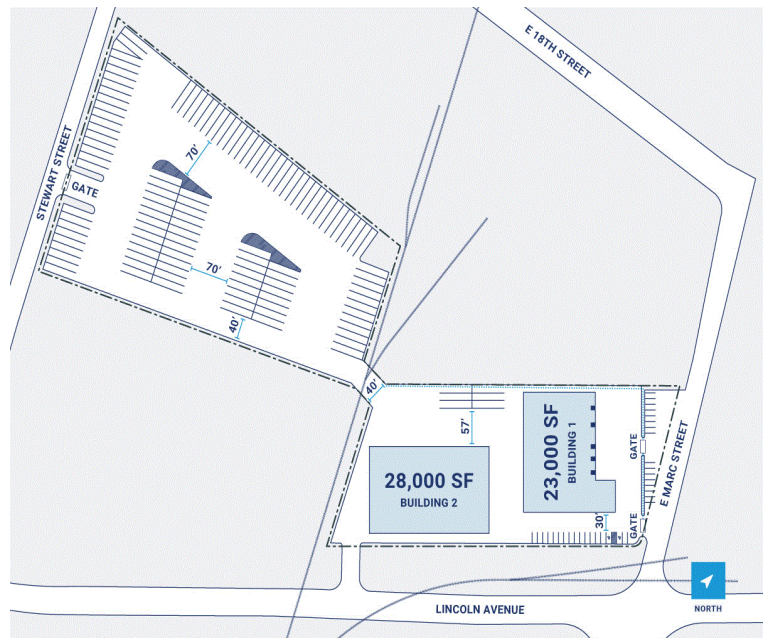

# CenterPoint Properties

1906-1916 E Marc Street, Tacoma, WA

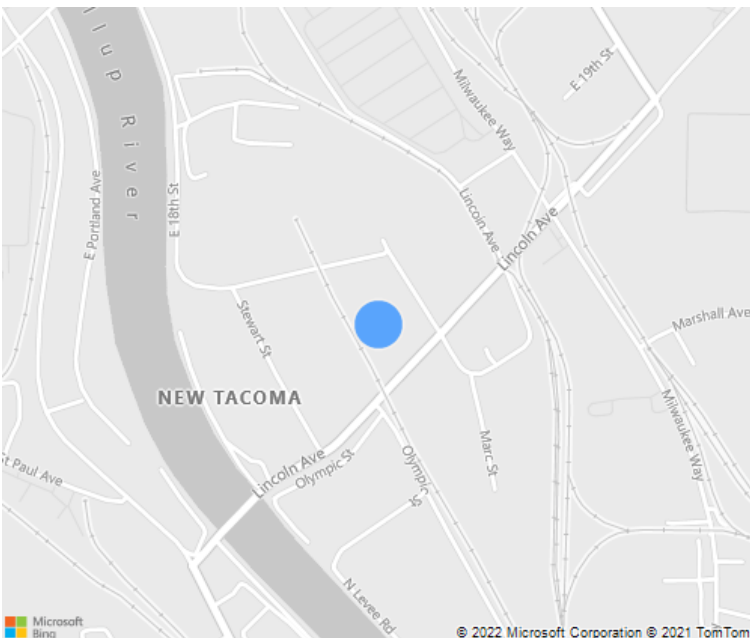

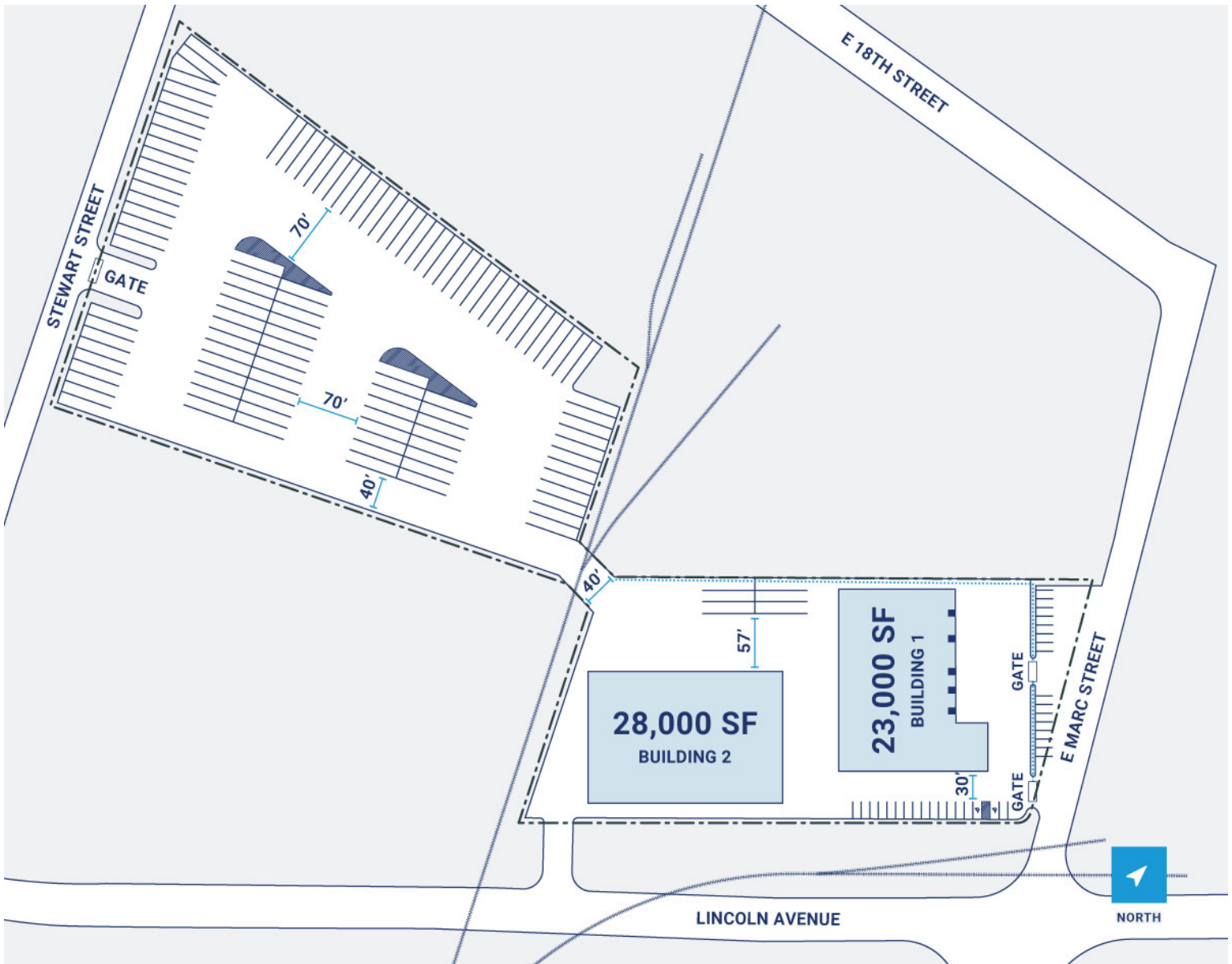

## Property Description

**Market:** Seattle

**Land:** 3 Acres

**Building:** 48,224 SF

**Office:** 2,000 SF

**Available:** SF

**Year Built:** 1968

**Rail Access:** No

**Renovated:** 2006

**Car Parking:** 16 spaces

**Trailer Parking:** 0 spaces

**Clear Height:** 28'

**Exterior Docks:** 6

**Interior Docks:** 0

**Drive-In Doors:** 4

**Construction:** Steel Warehouse Style

**Roof:** Metal and Built up

**HVAC:** No HVAC

**Sprinkler:** NA

**Power:** 1000 amps

**Typical Bay Size:** 0' x 0'

**Available Units:** 0