

3 Acres

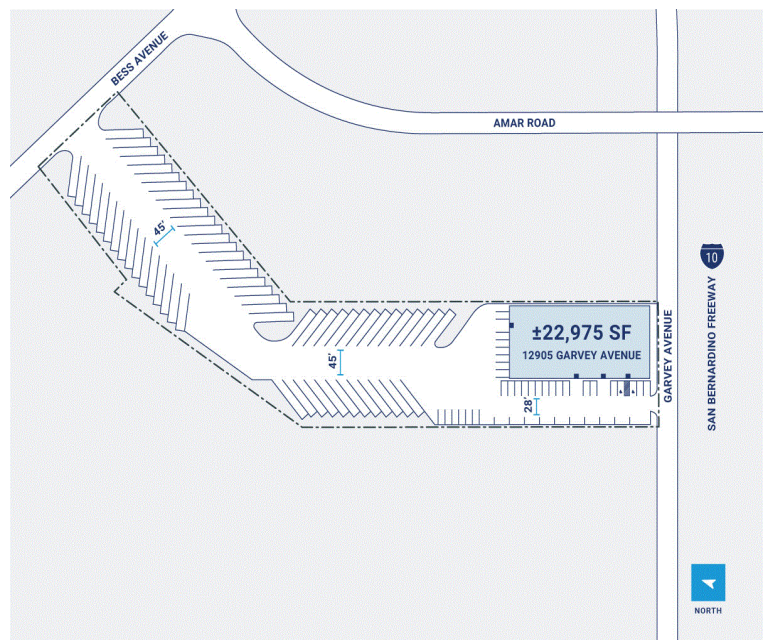

CenterPoint Properties

12905 Garvey Avenue, Baldwin Park, CA

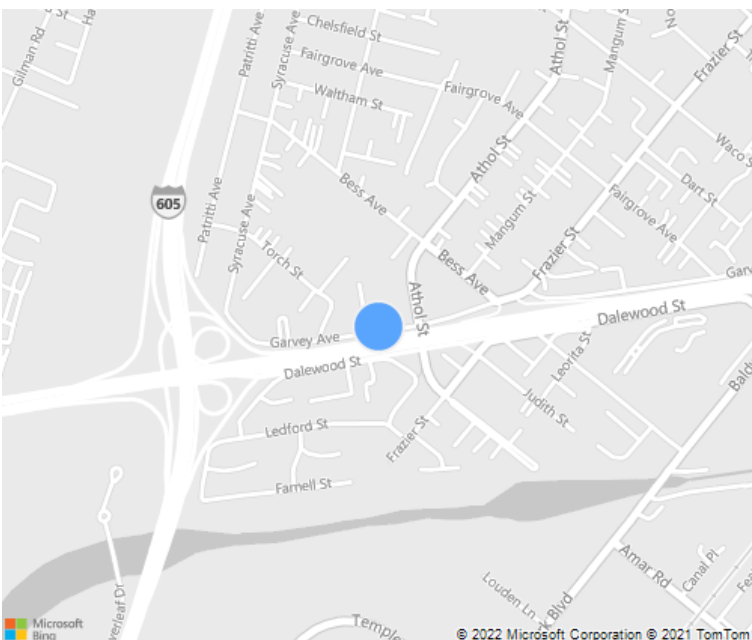

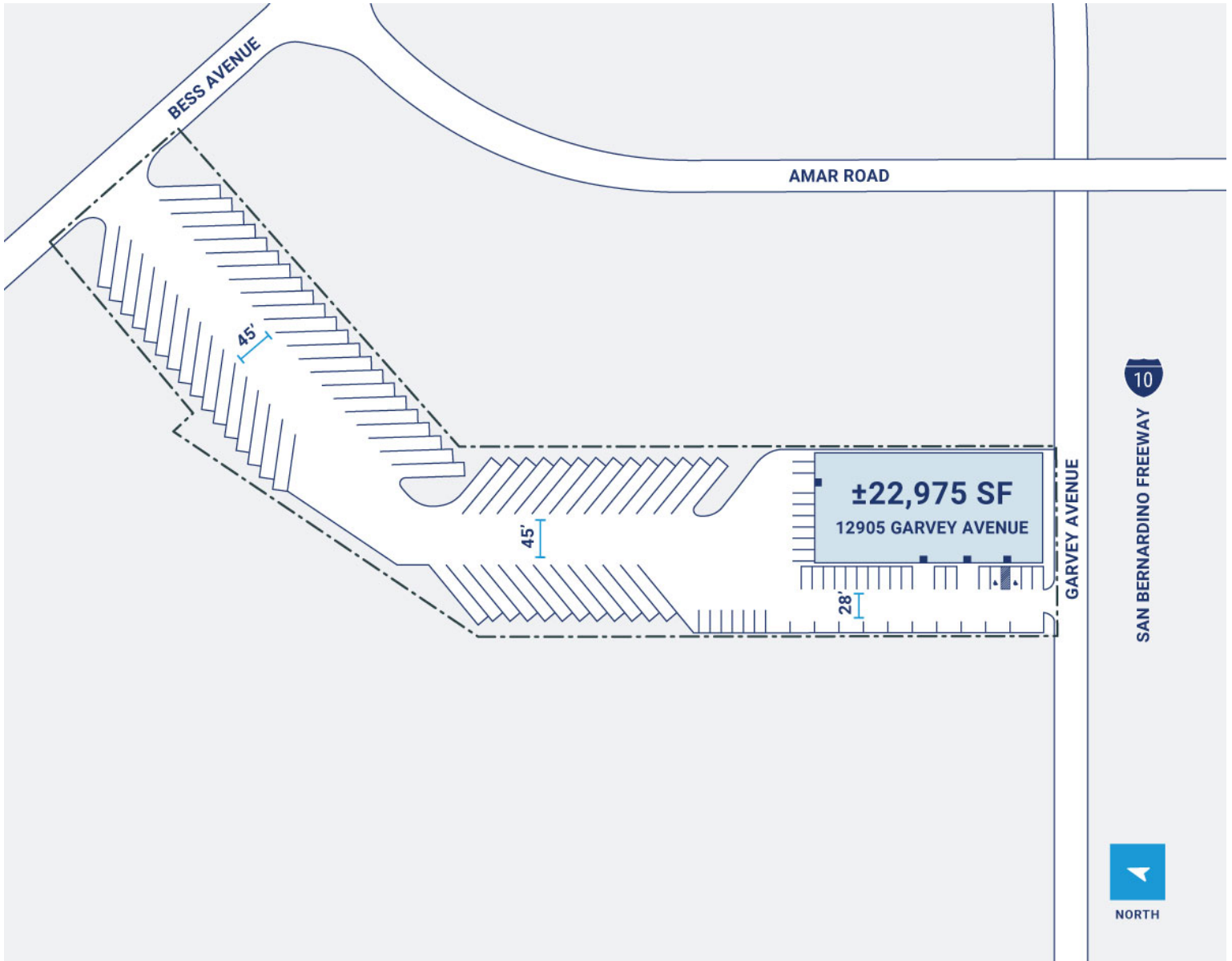

Property Description

Market: Los Angeles

Land: 3 Acres

Building: 22,975 SF

Office: 6,000 SF

Available: SF

Year Built: 1974

Rail Access: No

Renovated: 2019

Car Parking: 30 spaces

Trailer Parking: 0 spaces

Clear Height: 22'

Exterior Docks: 0

Interior Docks: 0

Drive-In Doors: 4

Construction: Concrete Tilt-up

Roof: Wood frame with BUR

HVAC: Gas Heat w/ AC

Sprinkler: N/A

Power: 800 amps

Typical Bay Size: 49' x 20'

Available Units: 0