

12 Acres

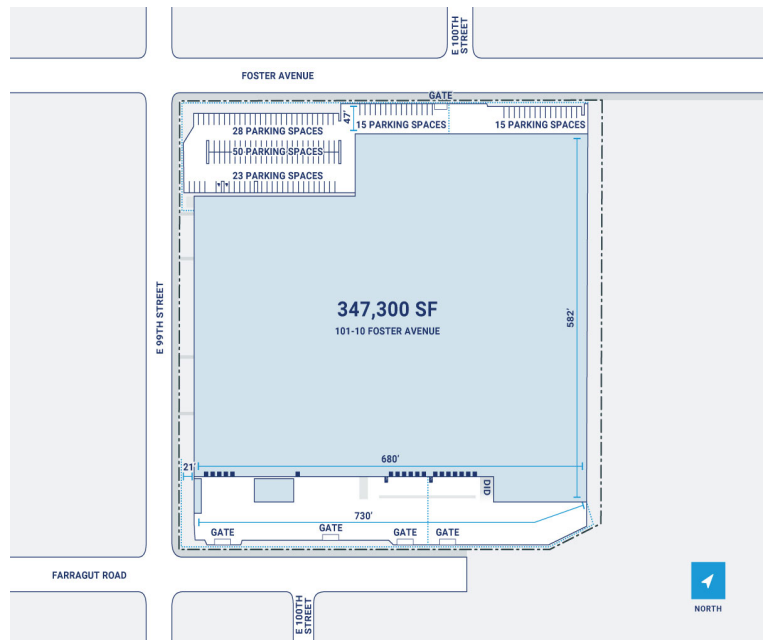

CenterPoint Properties

101-10 Foster Avenue, Brooklyn, NY

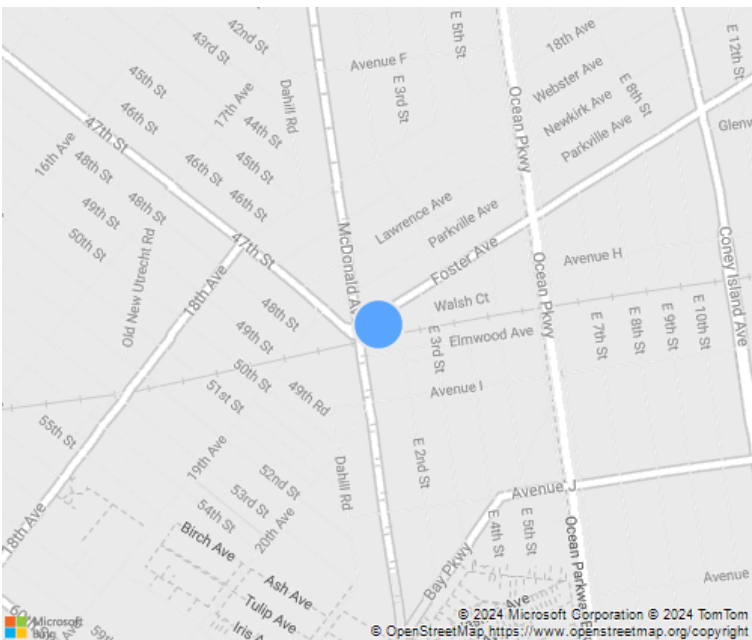

CenterPoint Properties

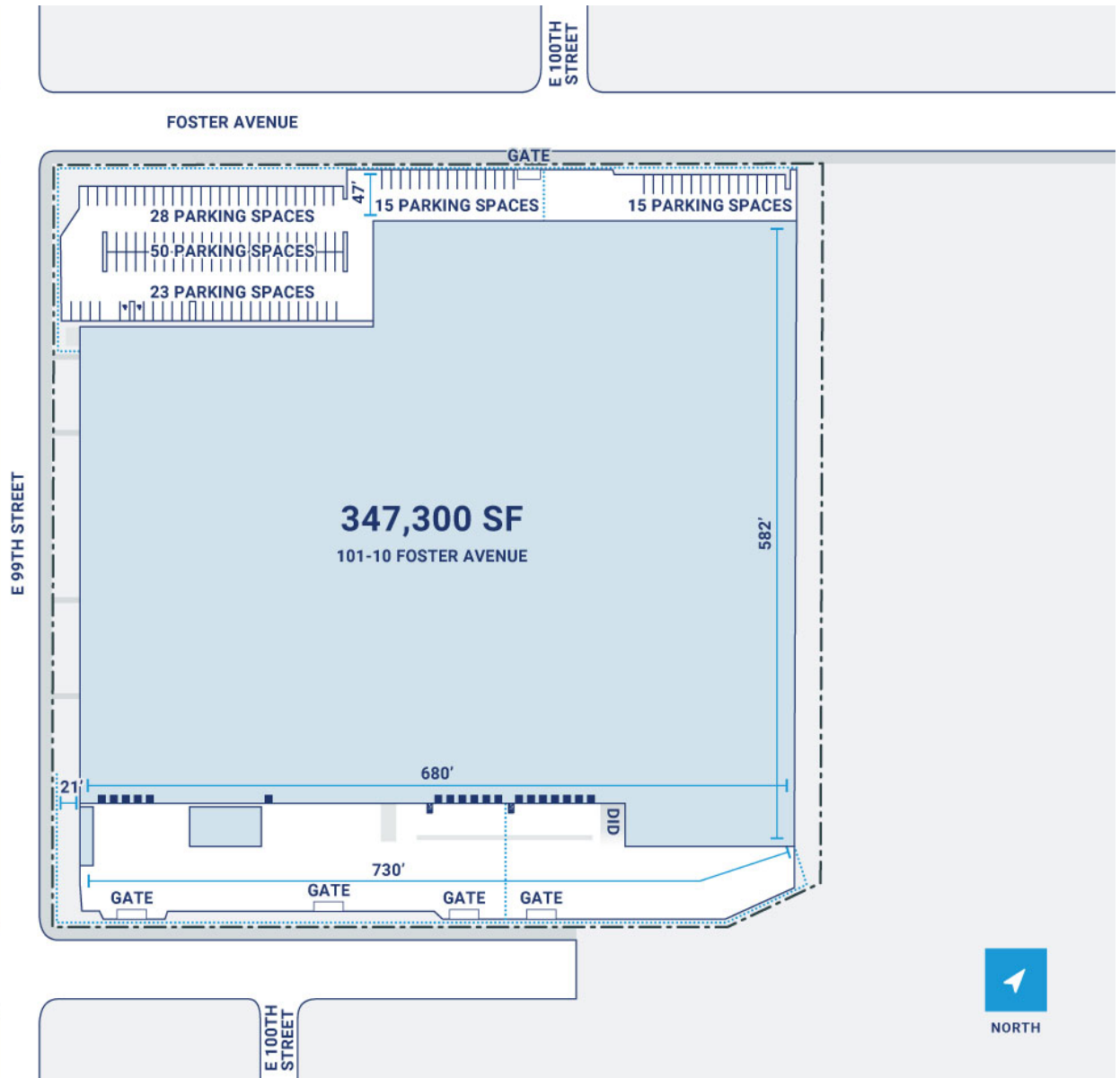

Property Description

Market: New Jersey/New York	Renovated:	Construction: CMU with interior steel framing
Land: 12 Acres	Car Parking: 245 spaces	Roof: EPDM
Building: 346,686 SF	Trailer Parking: 0 spaces	HVAC: Gas Heat w/ AC
Office: 35,432 SF	Clear Height: 11'	Sprinkler: Wet system
Available: SF	Exterior Docks: 17	Power: 480/277-volts, 3-phase
Year Built: 1971	Interior Docks: 0	Typical Bay Size: 40' x 40'
Rail Access: No	Drive-In Doors: 10	Available Units: 0