

8 Acres

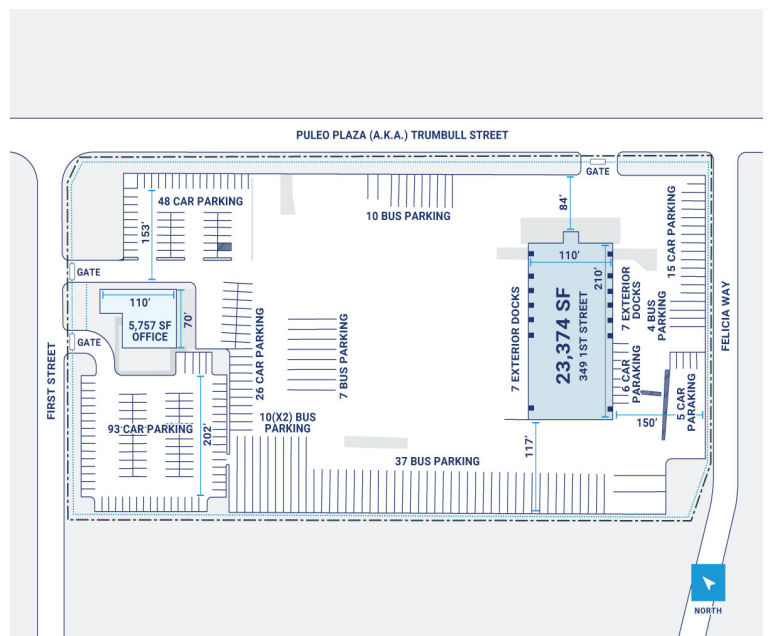

CenterPoint Properties

349-369 1st Street, Elizabeth, NJ

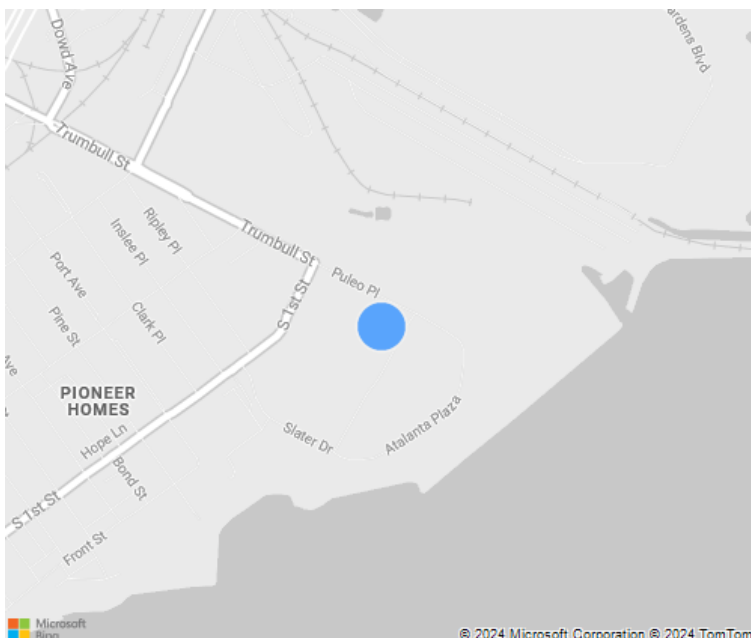

CenterPoint Properties

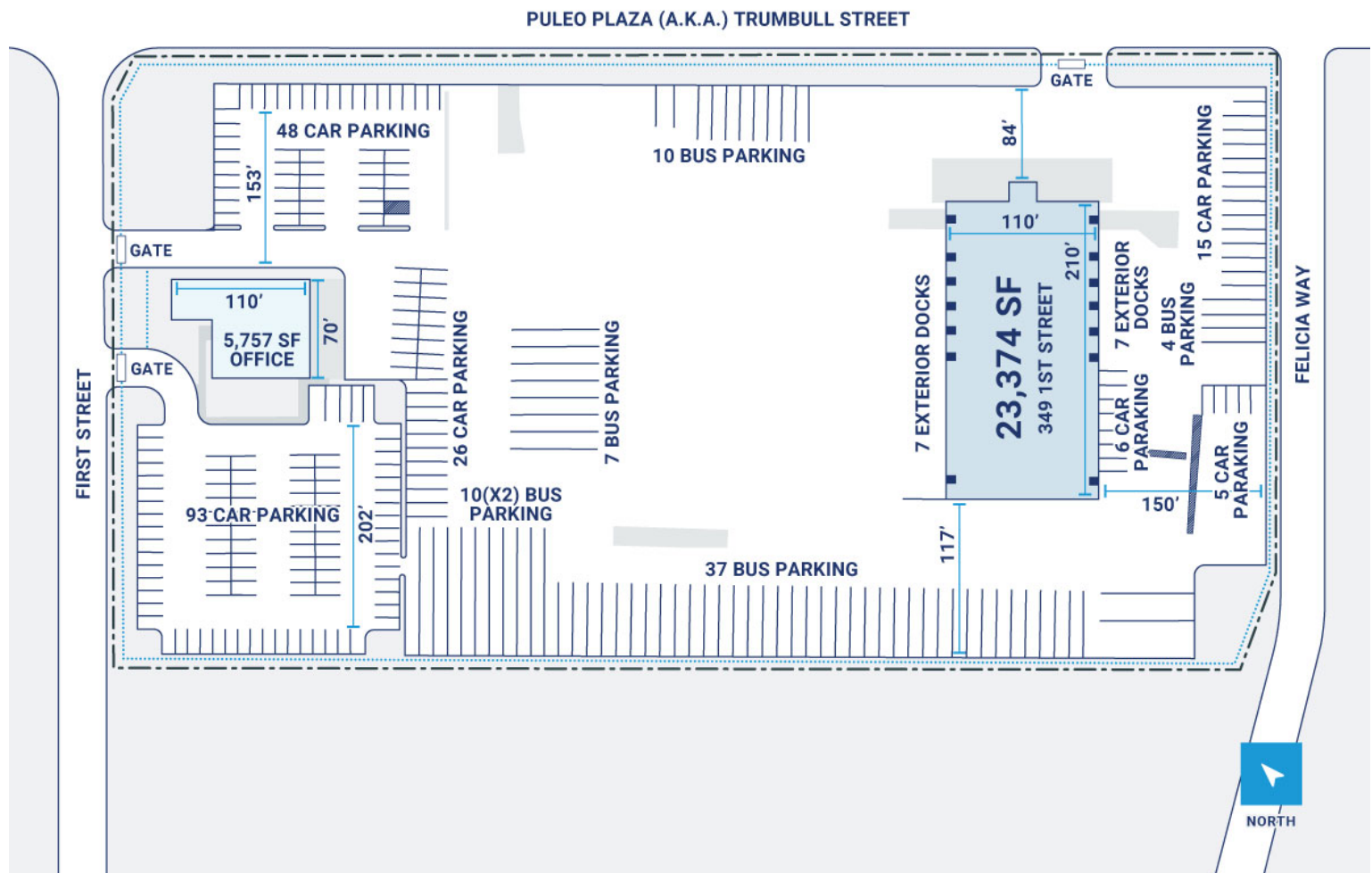

Property Description

Market: New Jersey/New York	Renovated:	Construction: Building 1: Stucco finished CMU infill walls with insulation
Land: 8 Acres	Car Parking: 193 spaces	Roof: Metal Roof
Building: 36,868 SF	Trailer Parking: 78 spaces	HVAC: Gas Heat
Office: 0 SF	Clear Height: 21'	Sprinkler: Wet System
Available: SF	Exterior Docks: 0	Power: 480/277-volts, 3-phase
Year Built: 2000	Interior Docks: 0	Typical Bay Size: 110' x 18'
Rail Access: No	Drive-In Doors: 16	Available Units: 0