

1 Acres

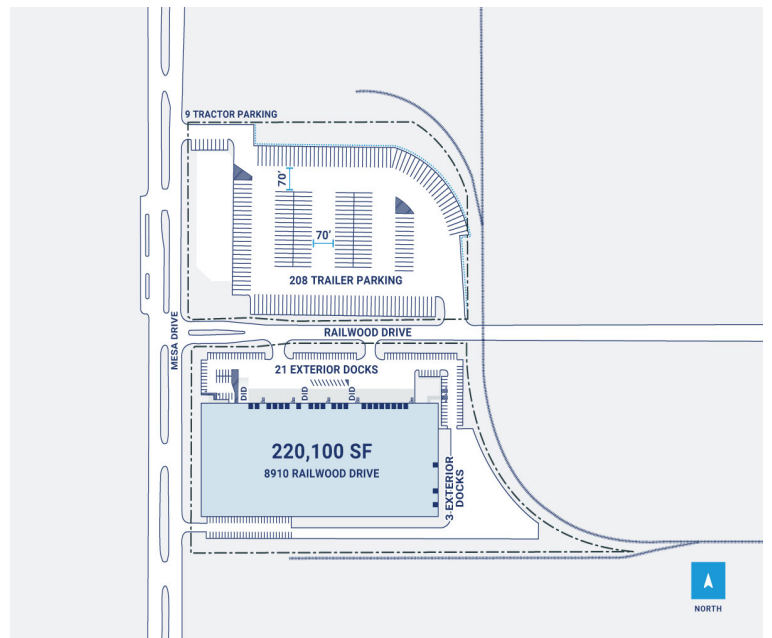

CenterPoint Properties

3101 E South Street, Long Beach, CA

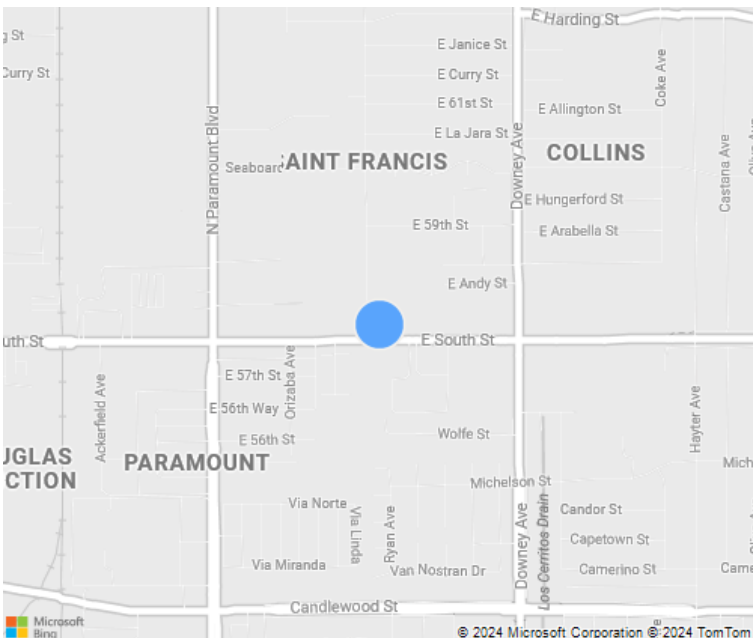

CenterPoint Properties

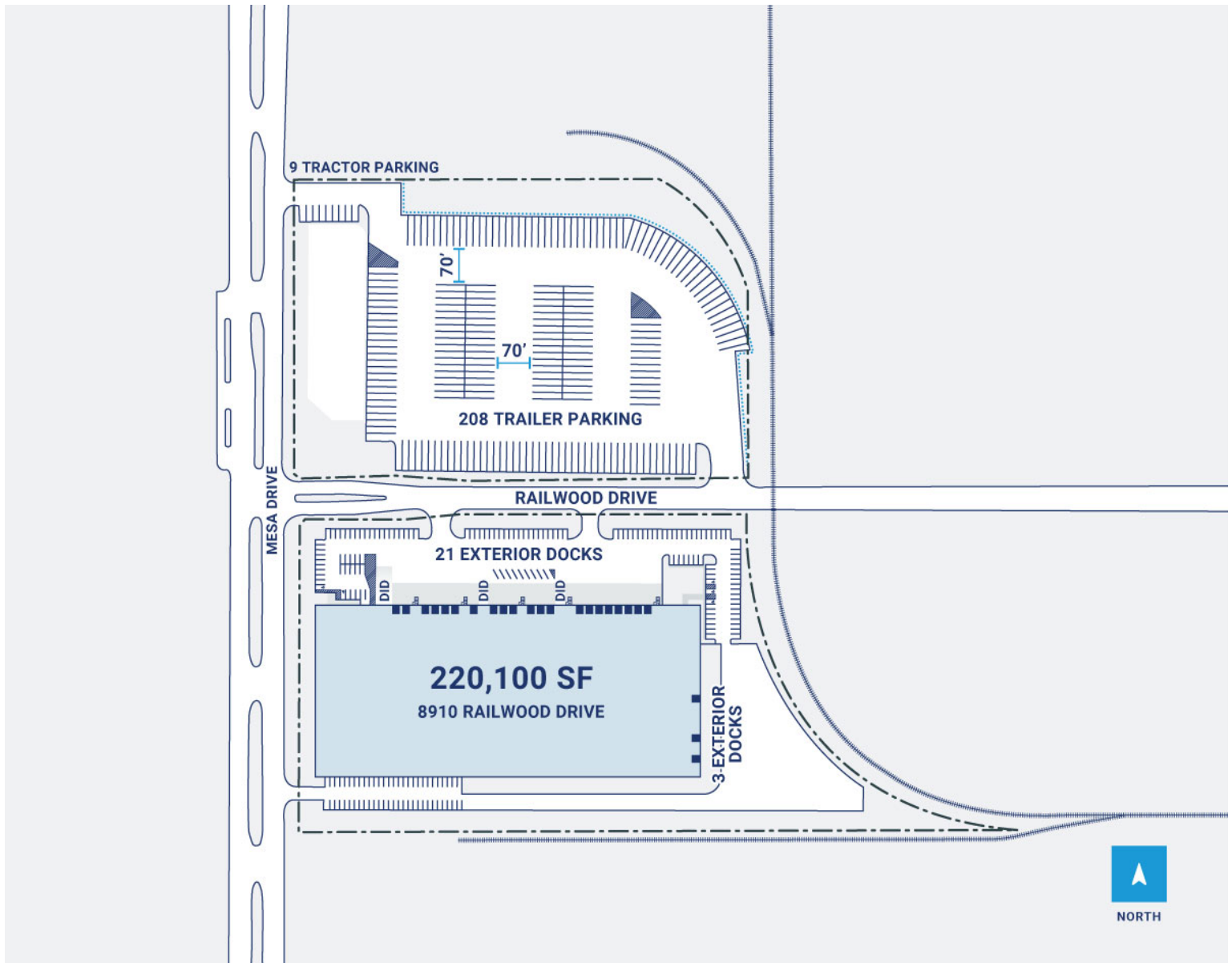

Property Description

Market: Los Angeles

Land: 1 Acres

Building: 9,672 SF

Office: 9,672 SF

Available: SF

Year Built: 1964

Rail Access: No

Renovated:

Car Parking: 47 spaces

Trailer Parking: 0 spaces

Clear Height: 0'

Exterior Docks: 0

Interior Docks: 0

Drive-In Doors: 0

Construction: Stucco

Roof: Built-up

HVAC: AC, Electric Heat

Sprinkler: N/A

Power: 2600 Amps

Typical Bay Size: 0' x 0'

Available Units: 0