

7 Acres

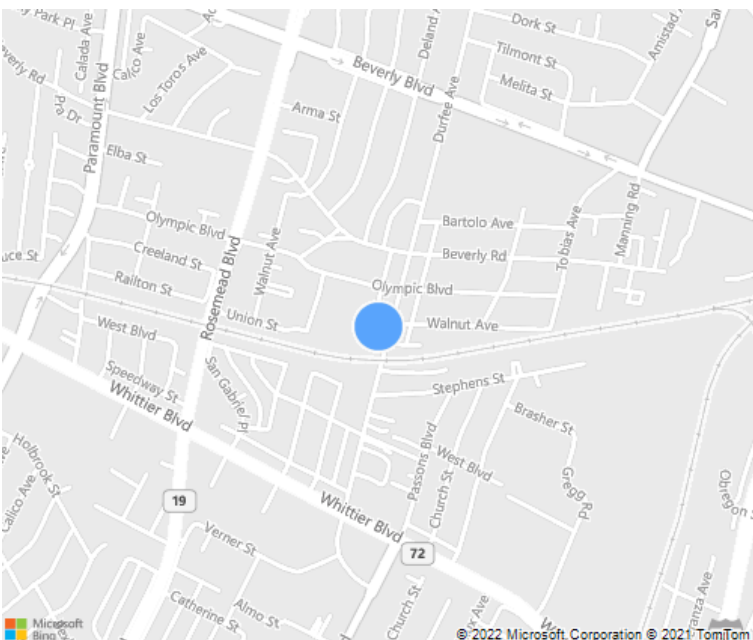

CenterPoint Properties

4739 Durfee Ave, Pico Rivera, CA



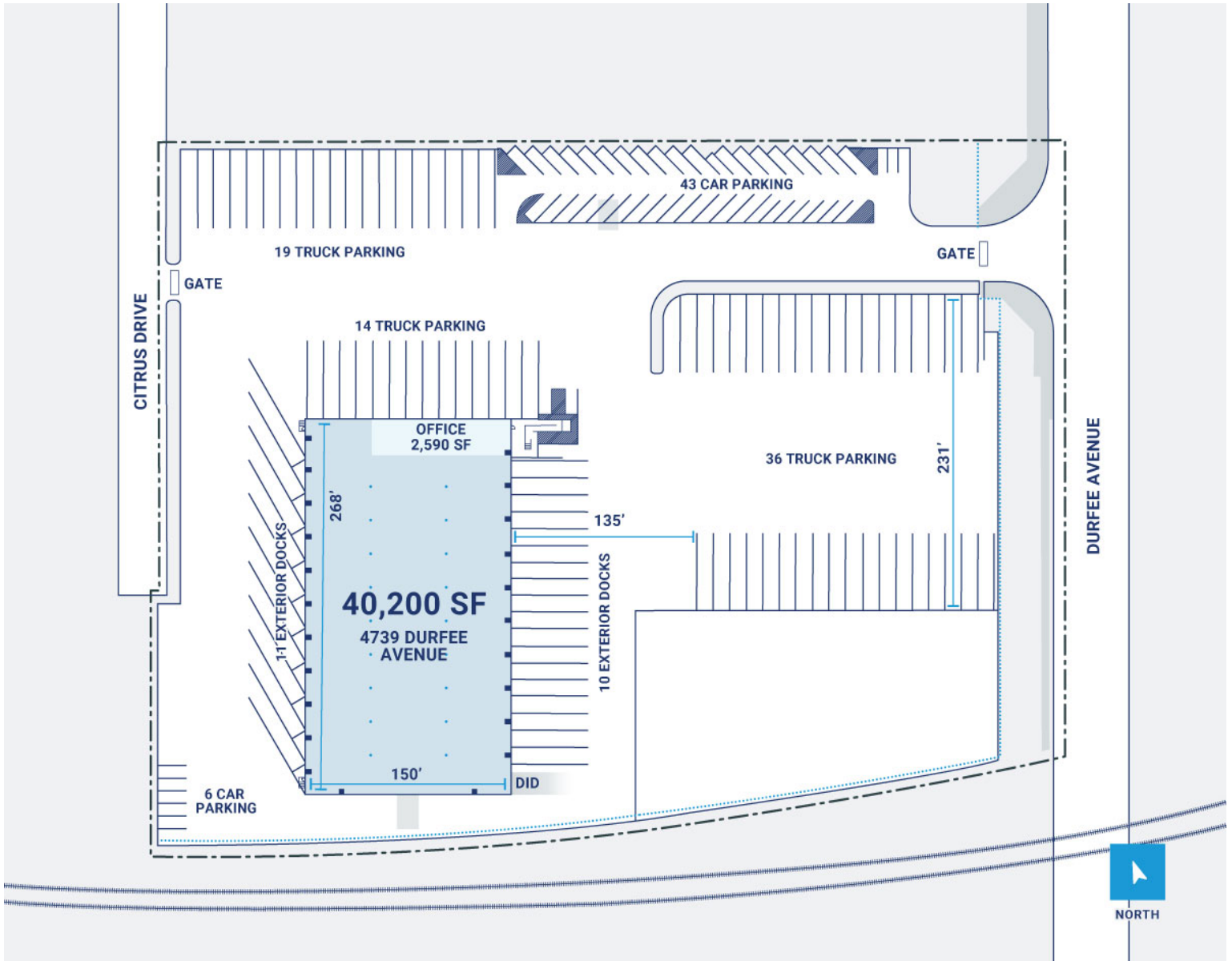

Property Description

Market: Los Angeles

Land: 7 Acres

Building: 40,238 SF

Office: 0 SF

Available: 40,238 SF

Year Built: 1964

Rail Access: No

Renovated:

Car Parking: 40 spaces

Trailer Parking: 80 spaces

Clear Height: 24'

Exterior Docks: 20

Interior Docks: 0

Drive-In Doors: 0

Construction: Concrete Bearing, Heavy Timber

Roof: Modified Bitumen

HVAC: Gas Heat w/ AC

Sprinkler: Wet system

Power: 400 amps, 480/277V

Typical Bay Size: 0' x 0'

Available Units: 1