

4 Acres

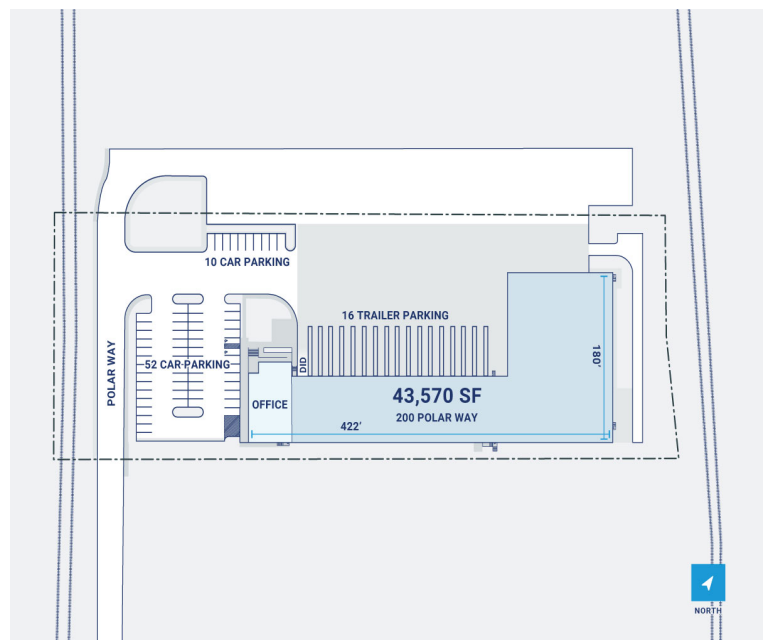

CenterPoint Properties

200 Polar Way , Jersey City , NJ

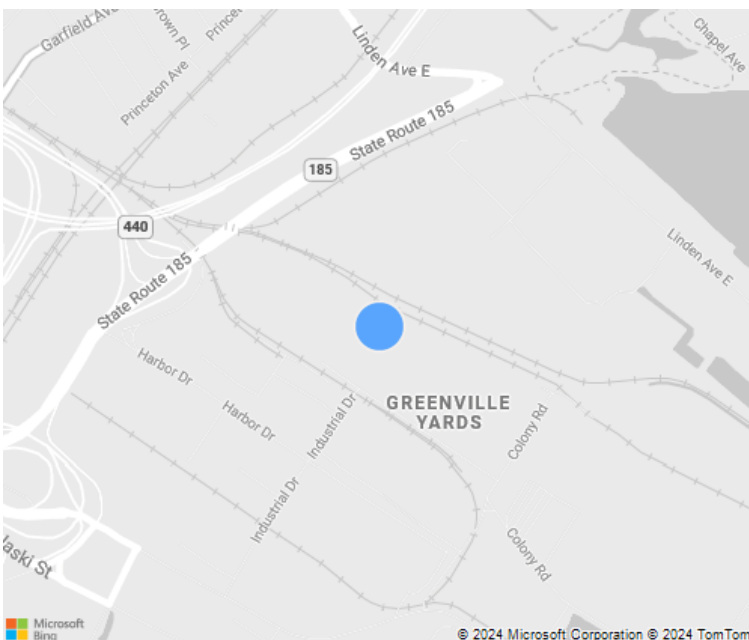

CenterPoint Properties

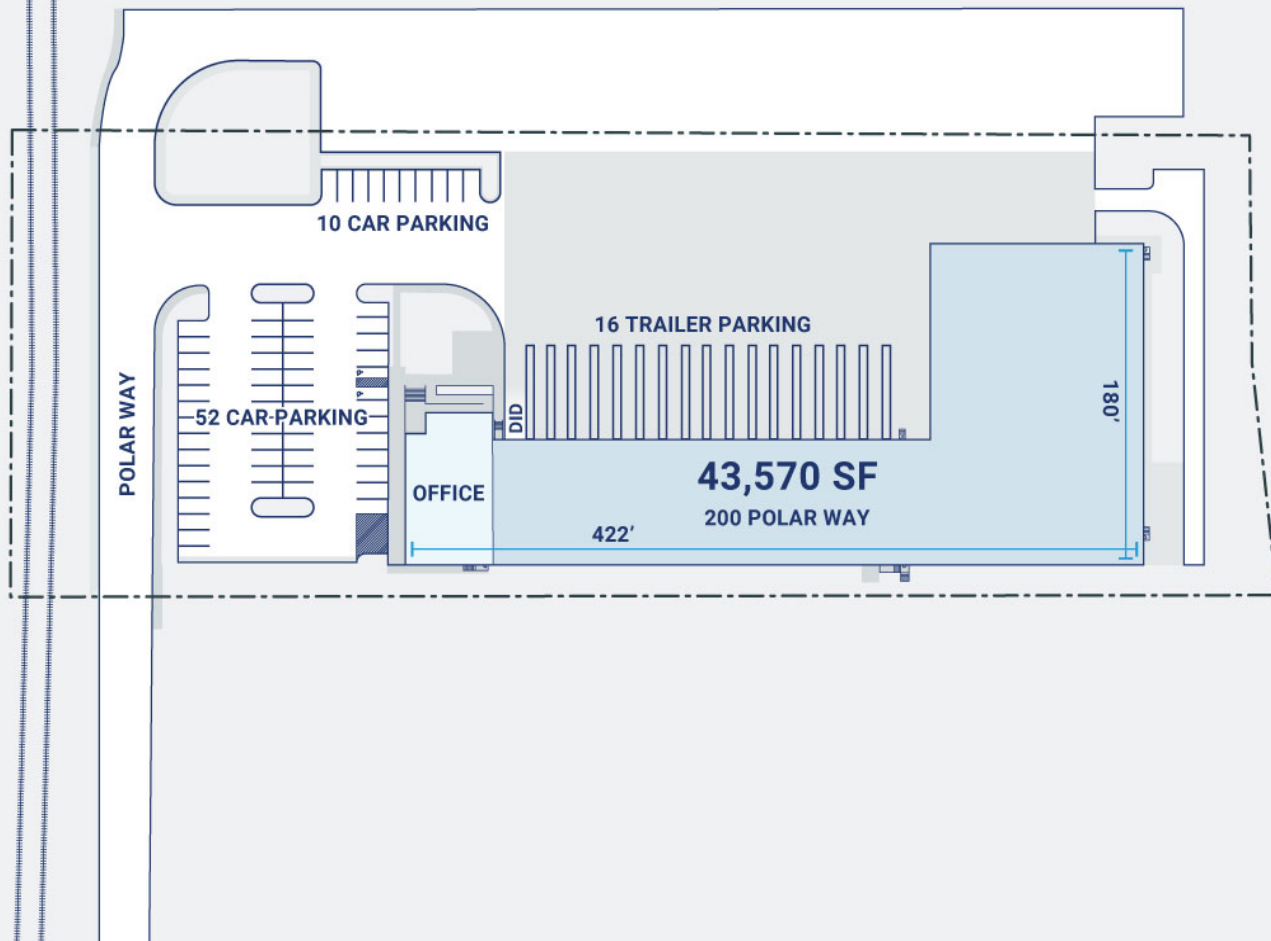

Property Description

Market: New Jersey/New York

Land: 4 Acres

Building: 49,500 SF

Office: 0 SF

Available: SF

Year Built: 2003

Rail Access: No

Renovated:

Car Parking: 62 spaces

Trailer Parking: 16 spaces

Clear Height: 33'

Exterior Docks: 16

Interior Docks: 0

Drive-In Doors: 1

Construction: Combination of tilt wall and insulated aluminum panel

Roof: Single-ply TPO

HVAC: Gas Heat w/ AC

Sprinkler: Standard, dry-type fire protection sprinkler system

Power: 1200 amps

Typical Bay Size: 250' x 0'

Available Units: 0