

4 Acres

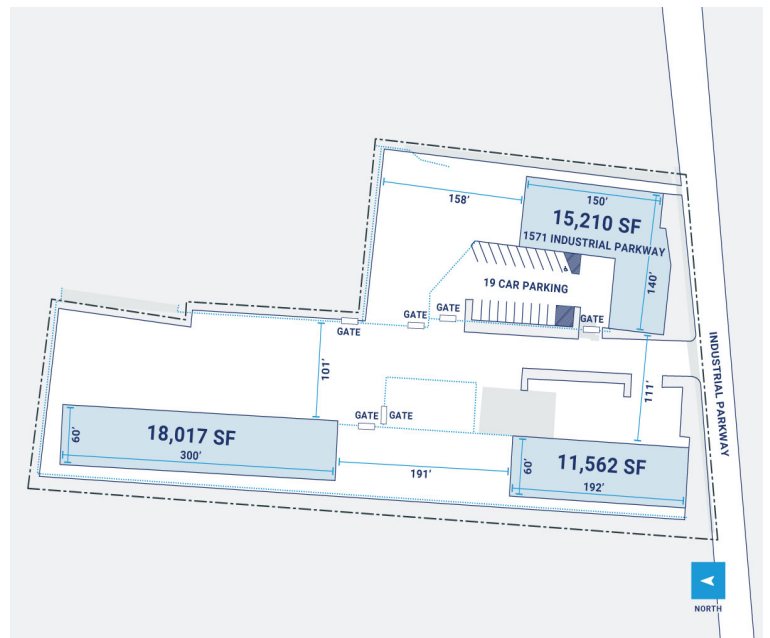

CenterPoint Properties

1565 & 1571 Industrial Parkway W, Hayward, CA

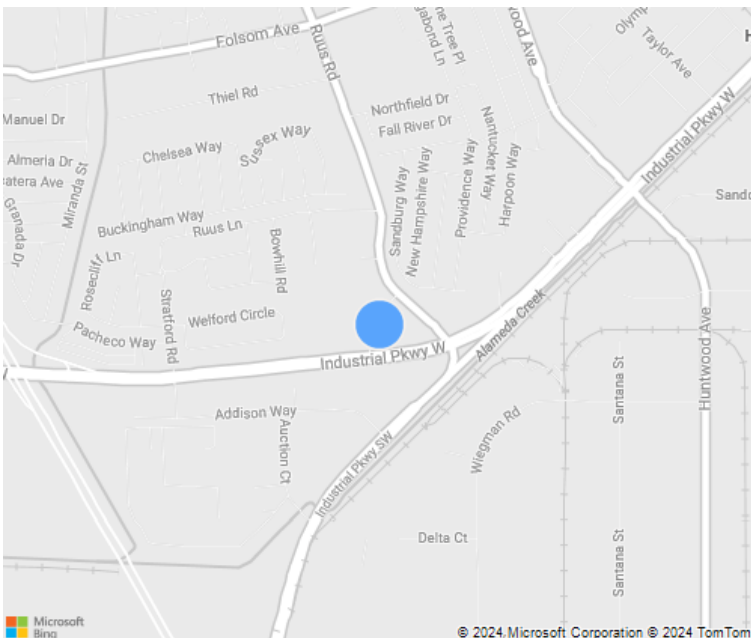

CenterPoint Properties

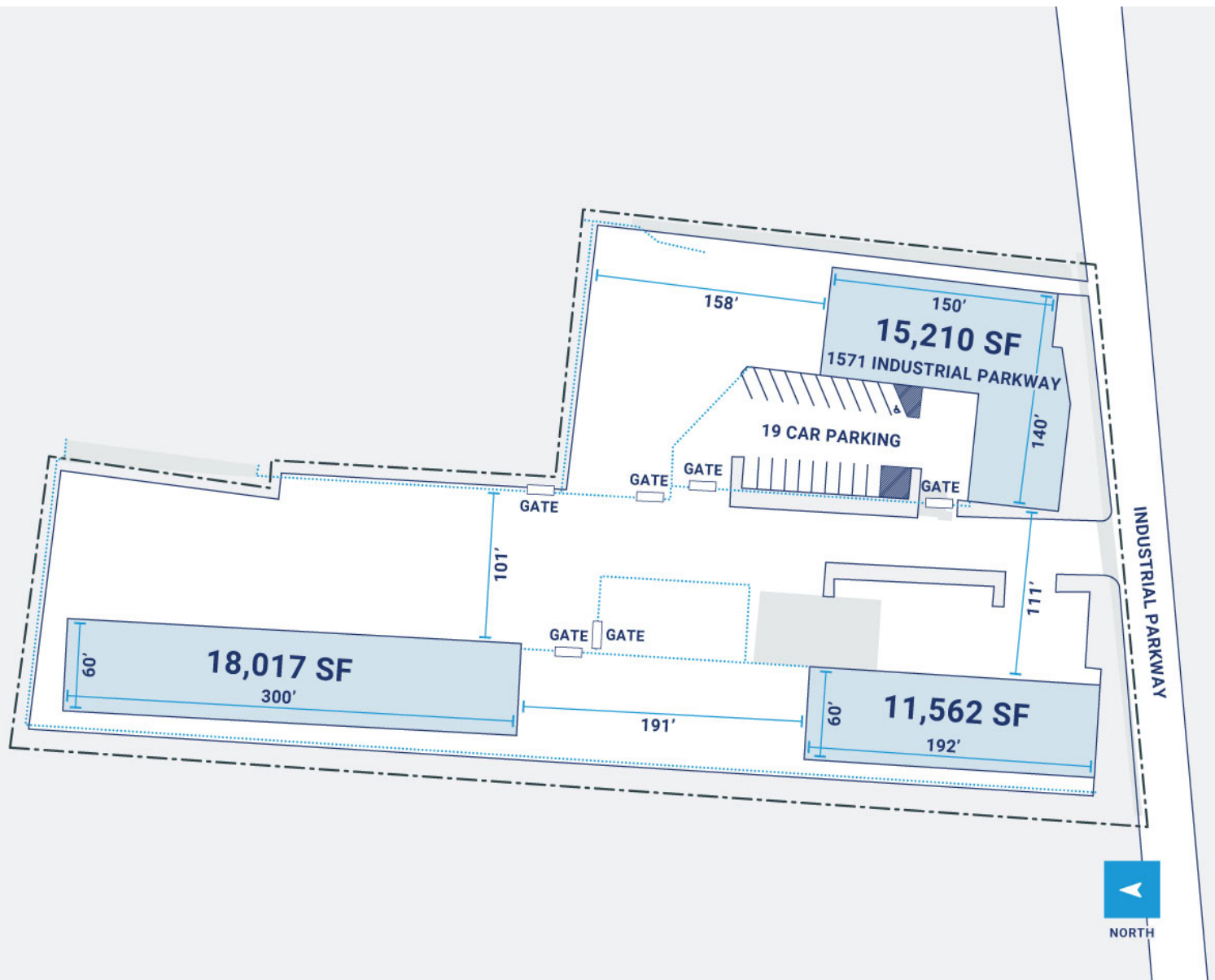

Property Description

Market: Oakland

Land: 4 Acres

Building: 18,017 SF

Office: 0 SF

Available: SF

Year Built: 1975

Rail Access: No

Renovated: 1988

Car Parking: 20 spaces

Trailer Parking: 0 spaces

Clear Height: 13'

Exterior Docks: 0

Interior Docks: 0

Drive-In Doors: 18

Construction: Corrugated metal panels

Roof: Corrugated metal panels

HVAC: Gas Heat, Gas Heat w/ AC

Sprinkler: N/A

Power: 480

Typical Bay Size: 0' x 0'

Available Units: 0