

4 Acres

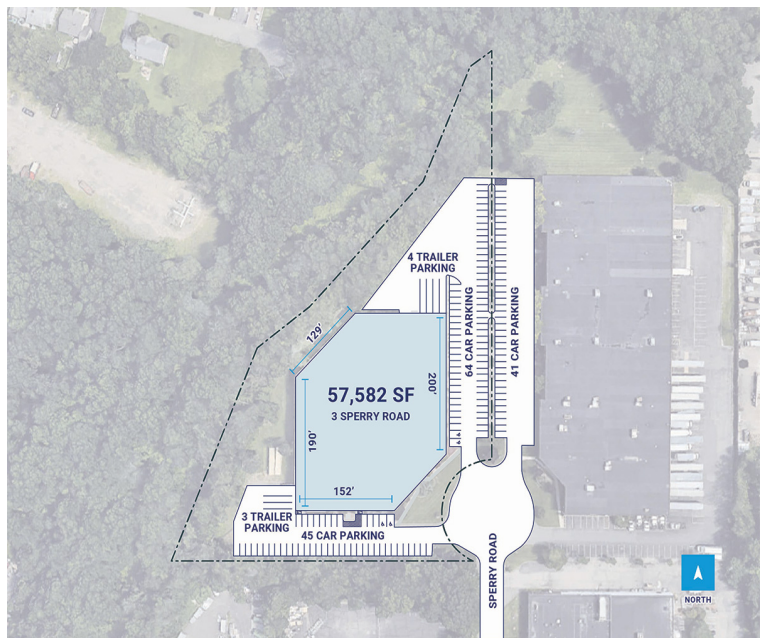

CenterPoint Properties

3 Sperry Road , Fairfield, NJ

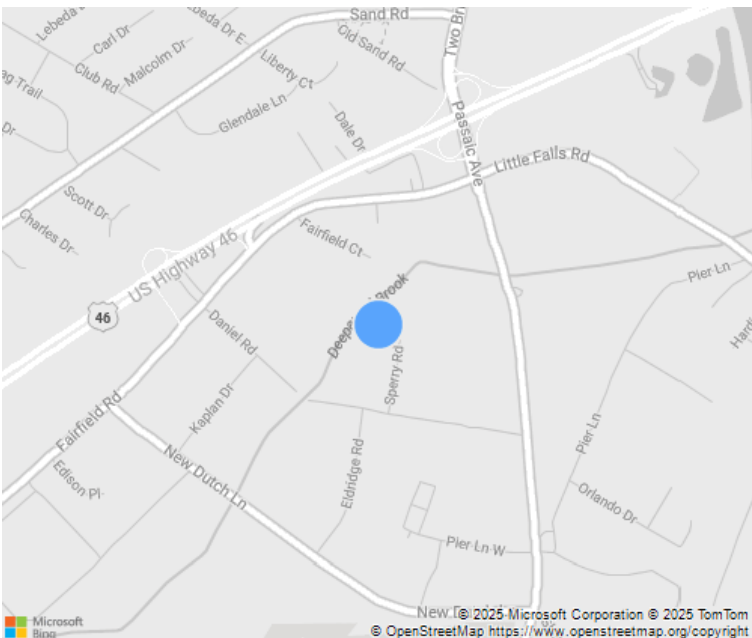

CenterPoint Properties

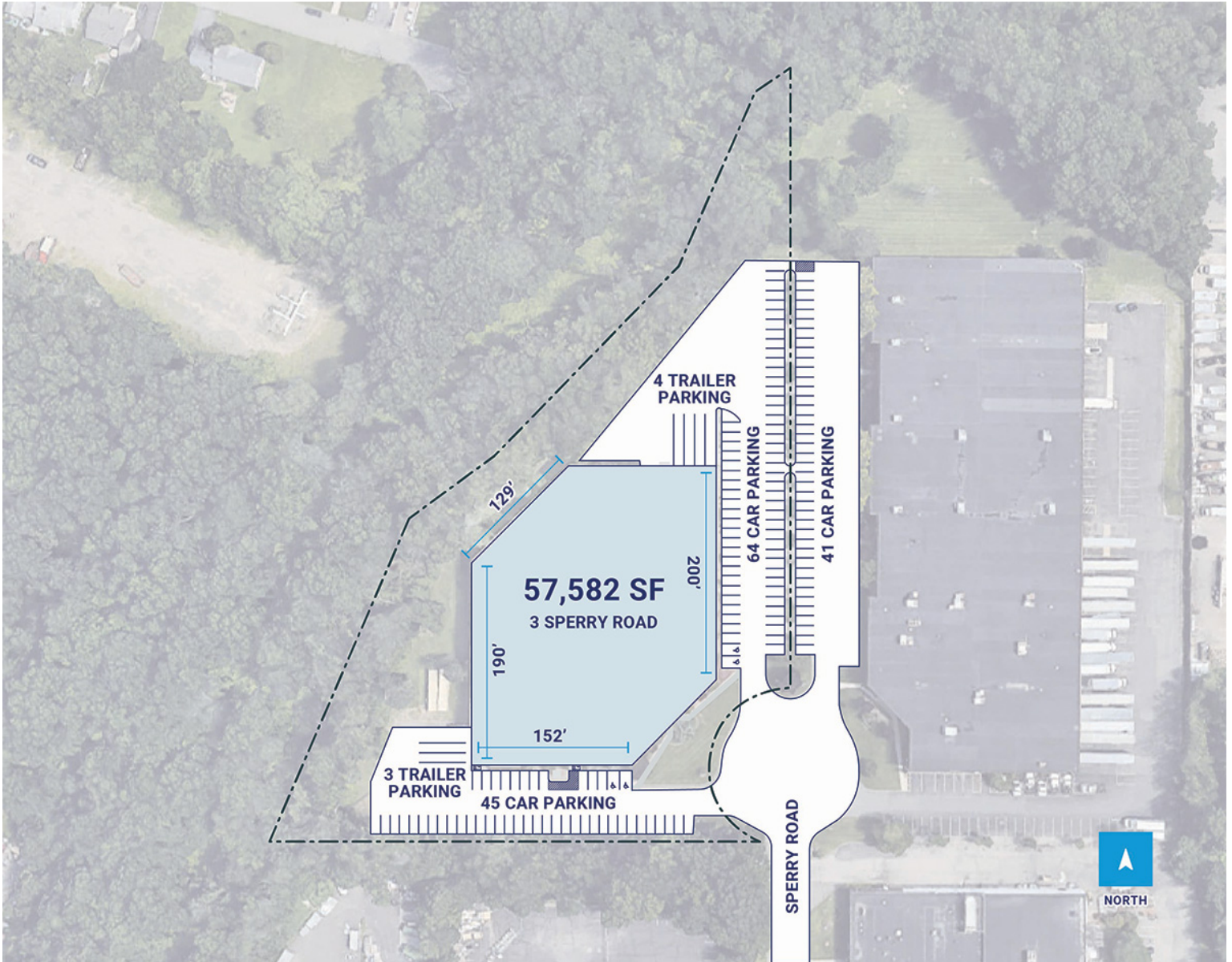

Property Description

Market: New Jersey/New York	Renovated:	Construction: Split face CMU block with limited aluminum ribbon window
Land: 4 Acres	Car Parking: 113 spaces	Roof: Flat/low-slope, ballasted, single-ply Versico TPO membrane
Building: 57,582 SF	Trailer Parking: 0 spaces	HVAC: Gas Heat w/ AC
Office: 0 SF	Clear Height: 20'	Sprinkler: Wet-pipe
Available: SF	Exterior Docks: 7	Power:
Year Built: 1981	Interior Docks: 0	Typical Bay Size: 10' x 10'
Rail Access: No	Drive-In Doors: 7	Available Units: 0