

1 Acres

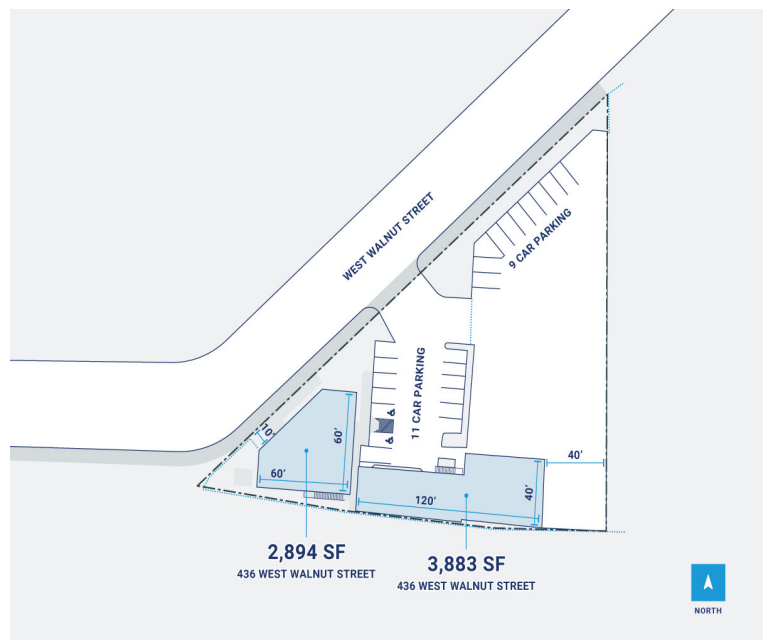

CenterPoint Properties

436 W Walnut Street, Gardena, CA

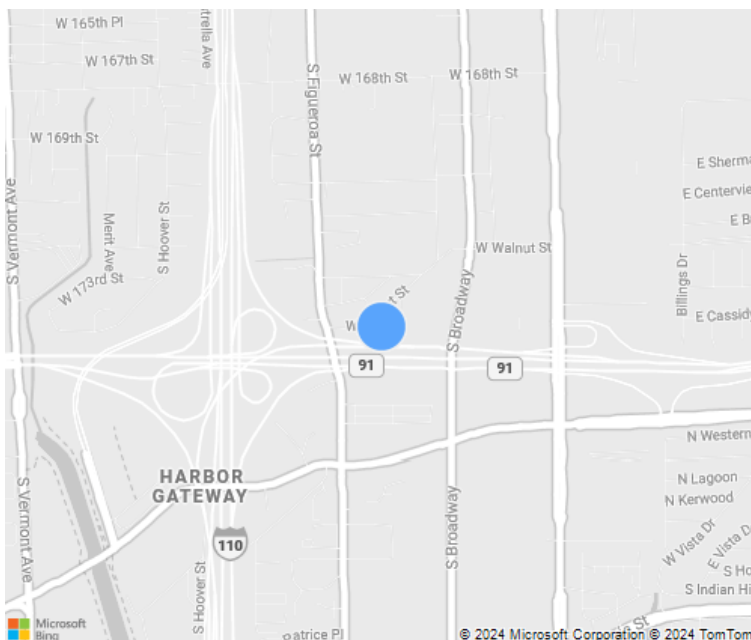
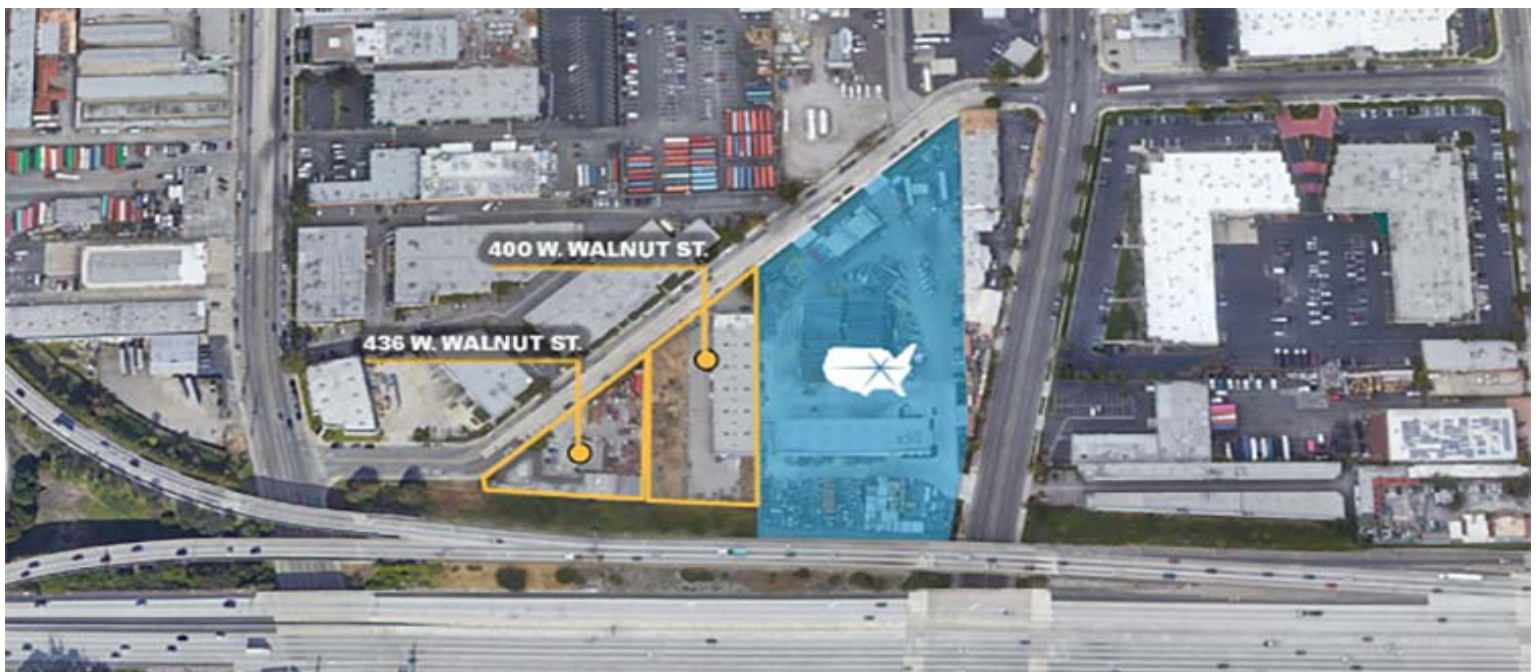

CenterPoint Properties

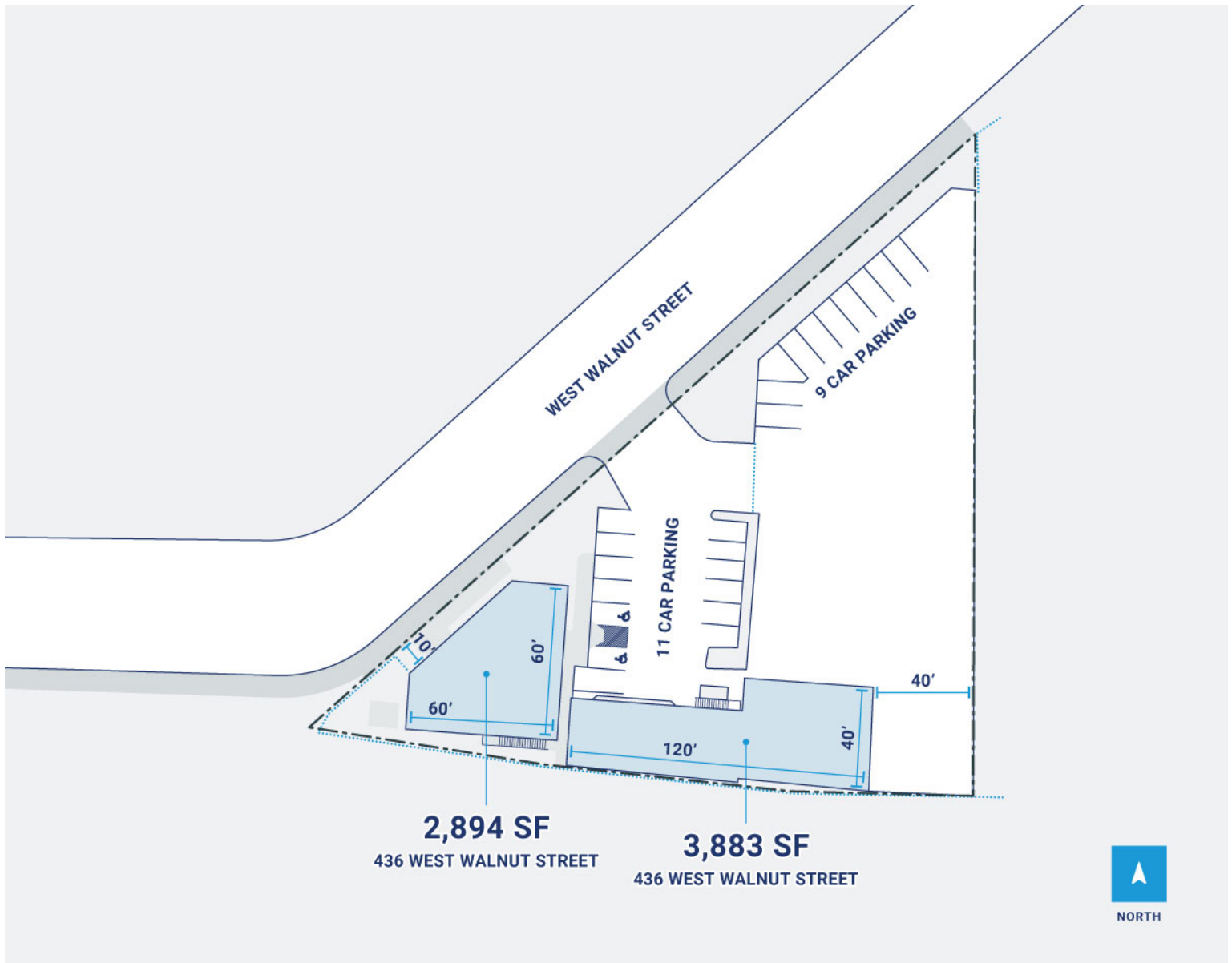

Property Description

Market: Los Angeles

Land: 1 Acres

Building: 14,250 SF

Office: 0 SF

Available: SF

Year Built: 1990

Rail Access: No

Renovated:

Car Parking: 22 spaces

Trailer Parking: 0 spaces

Clear Height: 18'

Exterior Docks: 0

Interior Docks: 0

Drive-In Doors: 2

Construction: Painted stucco, exposed architectural CMU

Roof: Flat/low-slope, built-up roofing with granular-surfaced modified

HVAC: Gas Heat w/ AC

Sprinkler: N/A

Power: 400 amp, 120/208-volt, 3-phase

Typical Bay Size: 0' x 0'

Available Units: 0